

Abercrombie & Kent



CRUISING ICELAND, THE FAROES, SCOTLAND & IRELAND (2025)

Venture off the beaten path on an all-new expedition revealing subarctic islands, volcanic landscapes, rugged coastlines and diverse birdlife.

Cruises, A&K Luxury Expedition Cruises



Europe, Iceland, Scotland,
Ireland



11 days from AU\$29,075 pp



148 Guests

Journey Overview

Venture off the beaten path with A&K's acclaimed team on an all-new expedition revealing subarctic islands, volcanic landscapes, rugged coastlines and diverse birdlife. Begin in the vibrant capital of Reykjavik, taking in the mainland's natural and cultural wonders before embarking on an exploration of the volcanic Westman Islands, postcard-perfect Faroe Islands, the Shetland Island's historic port of Lerwick, the castle-crowned Isle of Skye and Ireland's storied capital, Dublin.

Journey Highlights

- Cruise for 8 nights on an exclusively A&K chartered expedition as A&K's acclaimed team reveals volcanic wonders, seldom-visited subarctic islands, enchanting coastal cliffs and distinctive cities and towns both large and small
- Explore Reykjavik and Iceland's natural wonders with a three-day pre-cruise stay at The Reykjavik EDITION
- Embark on thrilling shore excursions revealing remote island villages and timeless port towns such as Lerwick
- Discover diverse marine and birdlife, including kittiwakes, guillemots, grey seals and orcas
- On the Isle of Skye, savour a curated tasting at the world-renowned Talisker Distillery
- Go back in time at historic sites like the Broch of Clickimin, an imposing fortification dating to the Iron Age



Itinerary

Aug 9: Arrive Reykjavik, Iceland

Arrive in Iceland's vibrant capital, a small city big on character. Reykjavik's manageable size makes it easy to explore its unique architecture, modern design vibe and bespoke, seaside-chic atmosphere. Upon arrival, you are transferred to your luxury hotel. Tonight, gather for a welcome reception and dinner.

The Reykjavik EDITION | Meals: D

Aug 10: Reykjavik | Explore Your Way

Today, choose your own adventure with included excursion options exploring near or far. Stay close with a walk down the wharf for a whale-watching cruise of Faxaflói Bay, or head into the city and its surrounds for a cultural and culinary tour visiting local museums with time to sample regional delicacies along the way. Venturing farther afield, you might opt for a rejuvenating soak in the scenic Sky Lagoon. Alternatively, embark on an epic exploration of Iceland's Golden Circle, taking in the historic sites of Thingvellir, the geothermal greenhouses of Fridheimar, the Strokkur geyser and the majestic falls of Gullfoss. Afterward, reconvene in Reykjavik for an evening at leisure.

The Reykjavik EDITION | Meals: BL

Aug 11: Reykjavik | Land of Fire & Ice

This morning, enjoy some time at leisure or opt for a walking tour of Reykjavik's iconic Hallgrímskirkja Cathedral, parliament building and harbour. After lunch, pass by the Hofdi house, site of the 1986 summit between Presidents Gorbachev and Reagan, followed by a viewing of the city's acclaimed Lava Show. End your day of exploration at the frigid wonders of Iceland's glaciers at the renowned Perlan Museum. Afterward, board your expedition vessel and embark for your first night aboard.

'Le Bellot' | Meals: BLD

Aug 12: Westman Islands | Shaped by Lava

Cruise amid the Icelandic Westman Islands and embark on an excursion to Heimaey, home to a former farming enclave forever changed by a volcanic eruption in 1973. Once ashore, you might opt to explore the lava fields and farmhouse ruins with your choice of an easy or more strenuous hike, followed by a visit to a local museum chronicling the site's legacy. Cruise onward for a Zodiac tour of Surtsey, a relatively new and starkly beautiful landmass formed by volcanic activity in the 1960s.

'Le Bellot' | Meals: BLD

Aug 13: At Sea | Cruising to the Faroe Islands

Unwind as you cruise eastward, enjoying the ship's amenities along the way. En route, the Expedition Team prepares you for tomorrow's exploration of the Faroe Islands with a series of enriching presentations.

'Le Bellot' | Meals: BLD

Aug 14: Faroe Islands, Denmark | Old Ways & Wild Vistas

Today, make landfall in Torshavn, the diminutive capital of the Faroe Islands. Though part of the Kingdom of Denmark, the Faroes are a fiercely independent, self-governing archipelago of 18 rocky, volcanic islands. Here, you might opt for a walking tour of the city, its National Museum and a local brewery. Alternatively, explore the coastal and hillside villages of Hvalvik, Saksun and Gjogv, rugged island enclaves boasting thatched dwellings, rich histories and postcard vistas visiting a local farm. Or, head to the village of Vestmanna and board a boat for a birding tour of towering coastal cliffs harbouring thousands of puffins, fulmars and guillemots. Cap this excursion off with a scenic hike revealing hidden lakes, pristine waterfalls and stunning views of the islands beyond.

'Le Bellot' | Meals: BLD

Aug 15: Shetland Islands, Scotland | Outpost of Lerwick

Cruise to Scotland's most northerly outpost, the Shetlands, and come ashore in the islands' only town, Lerwick. Wild and remote, the Shetland Islands harbour liberal doses of both Norse and Gaelic influences in their distinctive local culture. You might choose to explore this enchanting island enclave with a tour of its port town and a local brewery; a panoramic drive through the countryside and a stop at the Shetland Museum and Archives; or a coastal walk to the Broch of Clickimin, an imposing fortification dating to the Iron Age.

'Le Bellot' | Meals: BLD

Aug 16: Shetland Islands | Wild Splendours of Noss

Continue to Noss, a remote Shetland Island enclave renowned for its spectacular seabird colonies, striking coastal cliffs, diverse marine mammals and sprawling wildflowers. Explore this wild island paradise with Zodiac excursions revealing towering cliffs abundant with nesting guillemots, gannets, fulmars and puffins, as well as shorelines and waters frequented by harbour seals, grey seals, otters and porpoises.

'Le Bellot' | Meals: BLD

Aug 17: Isle of Skye

Today, explore the mountain- and castle-crowned Isle of Skye. The second largest of Scotland's islands, Skye spans some 80 kilometres of misty moors, rugged mountains, pristine lochs and towering coastal cliffs. Come ashore in Portree, Skye's main port and the perfect staging point for the day's excursions. Opt for a walk amid Skye's Fairy Pools, atmospheric rock pools fed by mountain springs; a scenic drive to Dunvegan Castle, the oldest continuously inhabited castle in Scotland; or a tour and tasting at Talisker Distillery, a producer of whiskies renowned the world over.

'Le Bellot' | Meals: BLD

Aug 18: At Sea | Cruising to Dublin

Relish a day of relaxation aboard, perhaps enjoying some time in the spa or conversing with newfound friends. Your Expedition Team shares photos and memories from your journey, culminating in a gala farewell dinner.

'Le Bellot' | Meals: BLD

Aug 19: Depart Dublin, Ireland

Disembark in Dublin and continue on your post-tour extension, or transfer to the airport for your flight.

Meals: B

Journey Details

Note: Itinerary is for guidance purposes only and may be adjusted due to unforeseen circumstances, including weather, wildlife, ice, medical emergencies and other conditions beyond A&K's control at the sole discretion of the Captain.

This journey contains some active elements, including Zodiac boat excursions, walks over uneven terrain and optional, challenging hikes. Minimum age is 7 years.

Categories 4–8 include butler service aboard the ship.

First group event: welcome dinner on Aug 9.

Last group event: disembarkation by 9:00 a.m. on Aug 19.

Included with this Luxury Expedition Cruise

- An Exclusively Chartered, All-Inclusive Voyage Led by A&K's Expedition Team and Local Guides
- Airport Meet and Greet and Transfers
- Private Balcony with Every Onboard Accommodation and Butler Service with Every Suite
- Maximum Personnel-to-Guest Ratio of 1 to 1.2 and ship occupancy limited to 80 percent
- Culinary Program Featuring French-Inspired Cuisine, Including House Drinks, Afternoon Tea and Pastries
- 24-Hour Room Service and Breakfast in Bed on board
- Choice of Curated, All-Inclusive Shore Excursions
- Enrichment program, lectures and presentations
- Traveller's Valet® Laundry Service on board
- All Gratuities, Port Charges and Taxes
- Complimentary Wi-Fi on Board and in Hotels
- Onboard Service from an English-Speaking Staff, Including an Accredited Physician
- 24/7 A&K On-Call Support

Map



Extensions



Iceland's South Shore Pre-Tour Extension (2025)

[See Details](#)



Dublin Post-Tour Extension (2025)

[See Details](#)

Accommodation

Le Bellot



This incredible cruiser is in a class of its own. Every inch of *Le Bellot* is designed with comfort and luxury in mind. Unwind in spacious cabins, enjoying state-of-the-art facilities, as this elegant vessel transports you to some of the most beautiful destinations on the planet. With a restricted guest capacity, you'll feel the benefits of an intimate on-board atmosphere, coupled with access to remoter locations that are inaccessible to larger ships.

Accommodation is second-to-none and features stylish contemporary décor, a private balcony and an en-suite bathroom. On the lower decks, you'll find a range of guest amenities including the theatre, a boutique shop, and the main lounge. Relax by the outdoor heated pool and enjoy lunch at the alfresco grill restaurant. The spa and fitness centre can be found on the upper decks. Spend exciting days on the water, relaxing in ultimate opulence aboard this spectacular boat. Soak up the scenery from the observation deck, unwind with newfound friends in the panoramic lounge or get stuck into a gripping read borrowed from the library.

As your exciting journey unfolds, embark on an exciting programme of activities and excursions, specially curated by your on-board enrichment team. Made up of local naturalists, geographers, historians and expert Zodiac drivers, they're experts in the local landscape. After exciting days of

exploration, unwind on board *Le Bellot* and soak up scenic views from your private balcony or enjoy drinks over live music in the main lounge.

Le Bellot Details

- Overall length: 131 metres
- Beam: 18 metres
- Average speed: 15 knots
- Passenger decks: 6
- Passenger capacity: 184, but limited to 148 exclusively on A&K charters
- Crew and A&K staff: 122 (personnel-to-guest ratio of 1 to 1.2)
- Gross tonnage: 9,900 GRT
- Standards: USPHS – U.S. Coast Guard’s Rules Comfort Class 1 – “Clean” Ship Certification (meets or exceeds all IMO, EPA, IAATO and AECO operating standards)
- Technology: Advanced dynamic positioning system and highly efficient stabilisers
- Flag: French
- Language: English on all A&K charters

Le Bellot amenities

- Private balcony with every guest stateroom and suite
- Complimentary butler service with every category of suite (an exclusive on A&K charters only, including welcome champagne, nightly canapés, packing/unpacking on request and more)
- Stateroom and suite amenities include a hairdryer, large wardrobe and ample storage, safe, alarm clock, and Hermès bath products
- Stateroom and suite electricity: 220v outlets — Europe two-prong style (plus two 110/220 U.S. outlets)
- Sundeck and multiple outer-deck observation areas
- Outside heated pool
- Library with an impressive selection of books and games
- Two restaurants: the main dining room and an outdoor grill
- Open bar with beer, wine, spirits, cocktails, soft drinks, coffee, tea and mineral water (excludes premium wines and spirits)
- Two lounges with bars: the main lounge with live music and the panoramic lounge with a scenic terrace
- Complimentary 24-hour room service
- Complimentary in-cabin breakfast (upon request)
- Three passenger lifts
- Fitness centre with Kinesis® wall
- Full-service salon with spa, sauna and steam room
- Theatre with comfortable seating for all guests
- Boutique shop
- 24-hour medical facilities with a certified doctor
- A&K’s complimentary Traveller’s Valet® laundry service
- Complimentary wifi on A&K charters (due to remote destinations, access and speed may vary)

'Le Bellot' Deck Plan

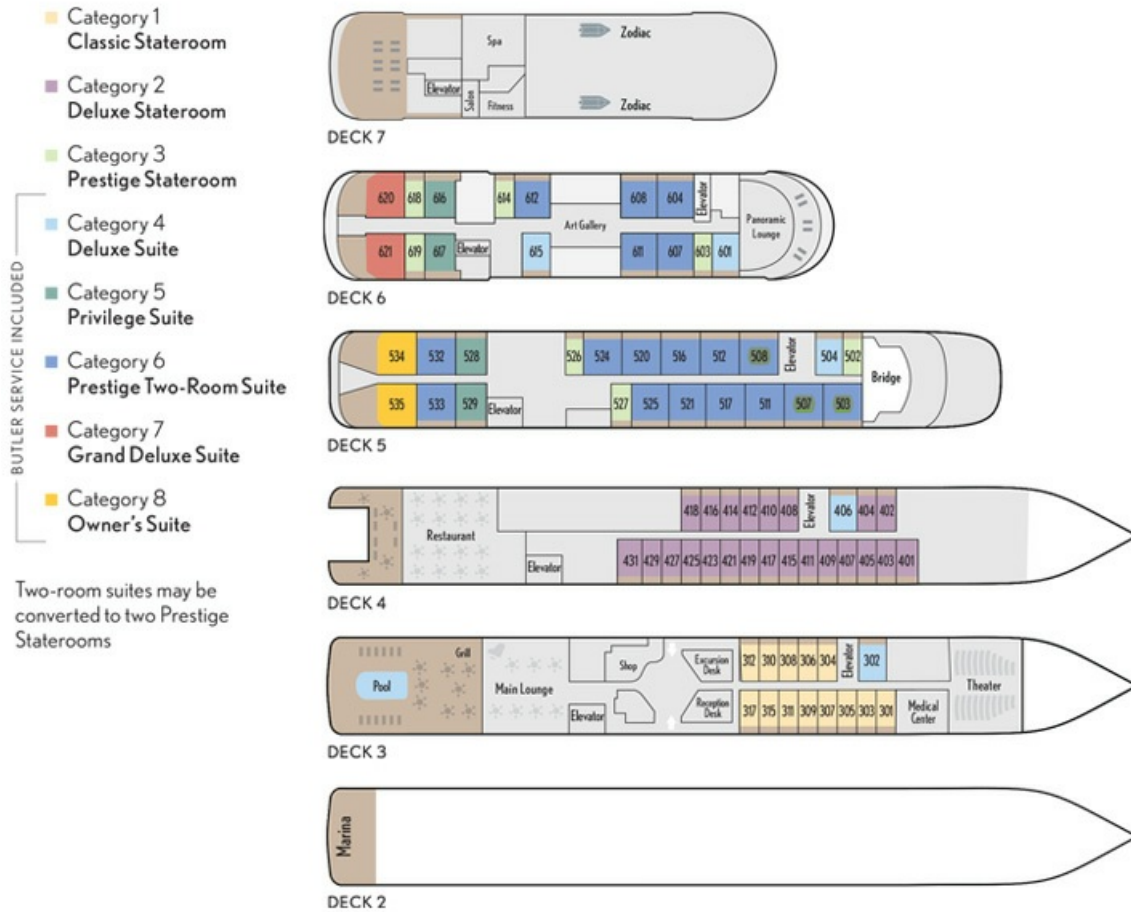

'Le Bellot' Cabin Layouts

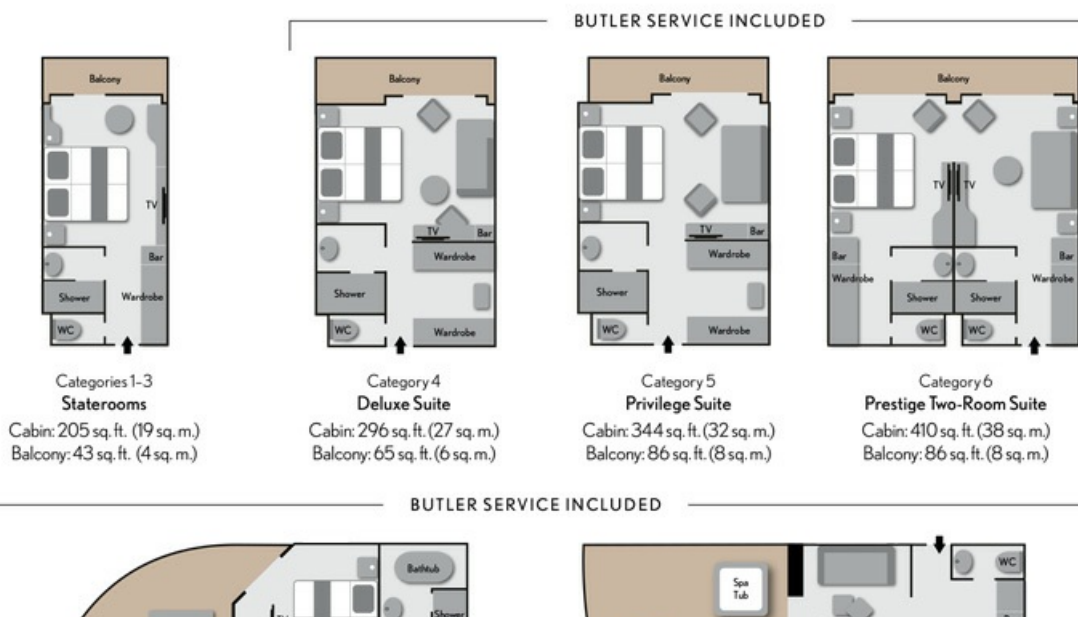

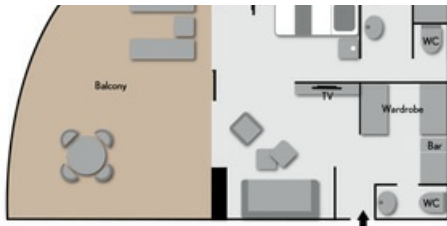

Category 7
Grand Deluxe Suite
Cabin: 485 sq. ft. (45 sq. m.)
Balcony: 322 sq. ft. (30 sq. m.)

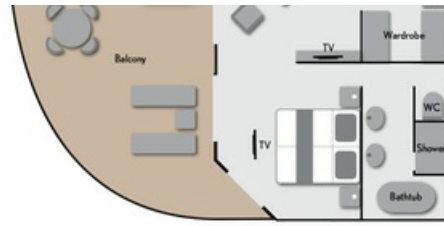

Category 8
Owner's Suite
Cabin: 485 sq. ft. (45 sq. m.)
Balcony: 430 sq. ft. (40 sq. m.)

Dates & Pricing

Prices are in AUD, per person, based on double occupancy

Aug 9, 2025 - Aug 19, 2025

Cabin Class	Price	Single	Internal Air	Availability
Le Bellot: Classic Balcony Stateroom - Category 1	AU\$29,075	Supplement	(From)	Call for
	pp	AU\$14,535	AU\$0	Availability
Cabin Class	Price	Single	Internal Air	Availability
Le Bellot: Deluxe Balcony Stateroom - Category 2	AU\$32,900	Supplement	(From)	Call for
	pp	AU\$16,445	AU\$0	Availability
Cabin Class	Price	Single	Internal Air	Availability
Le Bellot: Prestige Balcony Stateroom - Category 3	AU\$34,435	Supplement	(From)	Call for
	pp	AU\$17,215	AU\$0	Availability
Cabin Class	Price	Single	Internal Air	Availability
Le Bellot: Deluxe Balcony Suite - Category 4	AU\$52,035	Supplement	(From)	Call for
	pp	AU\$39,025	AU\$0	Availability
Cabin Class	Price	Single	Internal Air	Availability
Le Bellot: Privilege Balcony Suite - Category 5	AU\$56,630	Supplement	(From)	Call for
	pp	AU\$42,470	AU\$0	Availability
Cabin Class	Price	Single	Internal Air	Availability
Le Bellot: Prestige Two-Room Balcony Suite - Category 6	AU\$65,810	Supplement	(From)	Call for
	pp	AU\$49,355	AU\$0	Availability
Cabin Class	Price	Single	Internal Air	Availability
Le Bellot: Grand Deluxe Balcony Suite - Category 7	AU\$75,760	Supplement	(From)	Call for
	pp	AU\$56,855	AU\$0	Availability
Cabin Class	Price	Single	Internal Air	Availability
Le Bellot: Owner's Balcony Suite - Category 8	AU\$80,355	Supplement	(From)	Call for
	pp	AU\$76,345	AU\$0	Availability

Abercrombie & Kent

**Call Us Now on
1300 851 924
within Australia**

Melbourne Office:

T: +61 (0)3 9536 1800

F: +61 (0) 3 9536 1805

E: contact@abercrombiekent.com.au

Address

Level 26 (North Tower)

80 Collins St

Melbourne, VIC, 3000

International:

New Zealand Call: 0800 441 638

Asia Call: 800 4747 7700