

Abercrombie & Kent



## ANTARCTICA, SOUTH GEORGIA & FALKLANDS EXPEDITION (2026)

Explore the colourful Falkland Islands, unspoiled South Georgia with its rookeries of king penguins, and epic Antarctica.

---

Cruises, A&K Luxury Expedition Cruises



Antarctica



19 days from AU\$39,790 pp



199 Guests

## Journey Overview

Set off on a panoramic Luxury Expedition Cruise exploring the very best of the Southern Ocean. Perfect for photographers and explorers alike, this voyage reveals not only the wonders of Antarctica, but also breathtaking South Georgia and the starkly beautiful Falkland Islands — including the seldom-visited West Falkland. Go ashore with your Expedition Team to visit areas rich in the history of polar exploration and experience the region's fascinating wildlife in all its glory.

### Journey Highlights

- Cruise for 17 nights on an exclusively chartered voyage to Antarctica, South Georgia and the Falkland Islands
- Spend two days in the Falkland Islands to explore this remote archipelago's colourful, storied history and wildlife
- Explore historic, wildlife-rich South Georgia, where you visit spectacular king penguin colonies and legendary sites that tell the tale of Antarctica's greatest explorer, Sir Ernest Shackleton
- Experience the best of Antarctica during Zodiac excursions and time onshore led by A&K's award-winning Expedition Team
- Enjoy additional photo coaching, lectures and hands-on workshops from celebrated experts in the field
- Begin your adventure with a one-night stay in Buenos Aires, exploring this fiery Latin city



## Itinerary

### **Jan 7: Arrive Buenos Aires, Argentina**

Upon arrival in Argentina's capital, you are met and transferred to the Palacio Duhau — Park Hyatt Buenos Aires. In the evening, gather for a welcome cocktail reception.

***Palacio Duhau — Park Hyatt Buenos Aires***

### **Jan 8: Ushuaia | At the Edge of the World**

Fly to Ushuaia, the world's southernmost city and your gateway to Antarctica. Time permitting, you might opt for a trek in the Cerro Alarkén Nature Reserve before boarding your vessel and cruising out to sea.

***Le Lyrial | Meals: BLD***

### **Jan 9: The South Atlantic | Priming Your Lens**

Awake to your first morning aboard. Today, cruise east toward the Falkland Islands while A&K's Expedition Team begins its lectures with a focus on photography.

***Le Lyrial | Meals: BLD***

### **Jan 10: The Falkland Islands | Remote Island Outpost**

Today, your Captain may set a course for the remote Falkland Islands, a starkly beautiful sub-Antarctic enclave harbouring a wealth of marine and bird life. Weather permitting, take in the rugged beauty of the Falklands as you search for gentoo and rockhopper penguin colonies, and the majestic albatross.

***Le Lyrial | Meals: BLD***

### **Jan 11: The Falkland Islands | A Closer Look**

Conditions permitting, you may visit the historic capital of Stanley or explore its surrounding wilderness areas.

***Le Lyrial | Meals: BLD***

**Jan 12: The South Atlantic | On Whale Watch**

Today, your planned course continues toward South Georgia, one of the most beautiful places on earth. Whale sightings are common in this stretch of water.

***Le Lyrial | Meals: BLD***

**Jan 13: The South Atlantic | The Living Sea**

The open ocean is a treasure chest bursting with life. Scan the seas to spot seabirds and marine mammals as the ship cruises the nutrient-rich waters, perhaps passing the distinctive points of the Shag Rocks islets.

***Le Lyrial | Meals: BLD***

**Jan 14: South Georgia | Wildlife Haven**

The day's planned destination is South Georgia, one of the Southern Ocean's most biodiverse regions. Weather permitting, explore its rugged coves and shores, searching for vast colonies of king penguins.

***Le Lyrial | Meals: BLD***

**Jan 15: South Georgia | Shackleton's Legacy**

Today, you might learn about the exploits of Antarctic explorer Sir Ernest Shackleton as your A&K historian reveals significant whaling and exploration sites.

***Le Lyrial | Meals: BLD***

**Jan 16: South Georgia | Photographer's Paradise**

A photographer's paradise, South Georgia invites you to take your best shot. Conditions permitting, you may visit South Georgia's southern end, a vital habitat populated with fur seals, southern elephant seals and king penguins.

***Le Lyrial | Meals: BLD***

**Jan 17: The Scotia Sea | Enrichment at Sea**

Today's planned course plies the Scotia Sea. Prepare for your Antarctic arrival with lectures from the experts who know it best.

***Le Lyrial | Meals: BLD***

**Jan 18: The Scotia Sea | Antarctic Anticipation**

As Antarctica draws closer, your Expedition Team continues to build anticipation with insightful presentations. Between sessions, enjoy a drink and soak in the awe-inspiring views that surround you.

***Le Lyrial | Meals: BLD***

**Jan 19: Antarctica | Incredible White Continent**

Weather and ice conditions permitting, your Expedition Team takes advantage of the best opportunities for landings on the Antarctic Peninsula and the South Shetland Islands in search of gentoo and chinstrap penguins.

***Le Lyrial | Meals: BLD***

**Jan 20: Antarctica | Your Team Leads the Way**

Conditions permitting, get a closer look at the Antarctic Peninsula or the South Shetland Islands with your Expedition Team, perhaps encountering nesting giant petrels or skuas on your explorations.

***Le Lyrial | Meals: BLD***

**Jan 21: Antarctica | Wondrous Wilderness**

Antarctica invites another day full of photo ops as snowcapped mountains, shimmering glaciers and iceberg-strewn channels compete for your lens.

***Le Lyrial | Meals: BLD***

**Jan 22: Antarctica | A Parting Glimpse**

Pause to take it all in on this, your final day in Antarctica. Keep your eyes peeled for species that may have eluded your lens until this point.

***Le Lyrial | Meals: BLD***

**Jan 23: The Drake Passage | Storied Seas**

Bid farewell to Antarctica as your vessel returns north toward Ushuaia. While cruising this historic passage, keep watch for the giant petrel and the elusive albatross.

***Le Lyrial | Meals: BLD***

**Jan 24: The Drake Passage | Reflections at Sea**

The ship's transit through the Drake Passage is an interlude for recap and reflection, offering time to compare notes with your expert lecturers on the wildlife, history and geology of the White Continent.

***Le Lyrial | Meals: BLD***

**Jan 25: Depart Ushuaia**

After your scheduled arrival in Ushuaia, disembark and transfer for your connecting flight to Buenos Aires.

***Meals: B***

---

## Journey Details:

***Note: Itinerary is for guidance purposes only and may be adjusted due to unforeseen circumstances, including weather, wildlife, ice, medical emergencies and other conditions beyond A&K's control at the sole discretion of the Captain.***

Internal air included: Buenos Aires/Ushuaia/Buenos Aires

This journey contains some active elements, including Zodiac boat excursions, walks over uneven terrain and optional, challenging hikes.

Minimum age is 7 years.

Categories 4-9 include room upgrade at the hotel and butler service aboard the ship.

First group event: welcome reception on Jan 7.

Last group event: disembarkation by 9:00 a.m. on Jan 25.

## Included with this Luxury Expedition Cruise

- An Exclusively Chartered, All-Inclusive Voyage Led by A&K's Expedition Team
- Pre-Cruise Stay at Stylish, Ideally Located Hotel and A&K-Led Excursion
- Airport Meet and Greet and Transfers
- Private Balcony with Every Onboard Accommodation and Butler Service with Every Suite
- Maximum Personnel-to-Guest Ratio of 1 to 1.2 and ship occupancy limited to 80 percent
- Culinary Program Featuring French-Inspired Cuisine, Including House Drinks, Afternoon Tea and Pastries
- 24-Hour Room Service and Breakfast in Bed on board
- Complimentary Expedition Parka, Backpack and Water Bottle, and Use of Waterproof Pants, Boots and Trekking Poles
- Zodiac Excursions Led by A&K Expert Naturalist Driver-Guides
- Traveller's Valet® Laundry Service on board
- All Gratuities, Port Charges and Taxes
- Complimentary Wi-Fi on Board and in Hotels
- Onboard Service from an English-Speaking Staff, Including an Accredited Physician
- 24/7 A&K On-Call Support

# Map





## Extensions

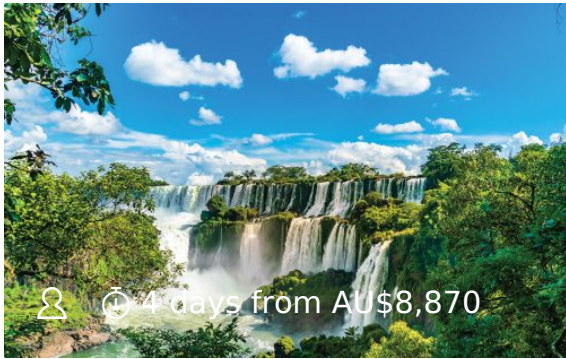

Iguazu Falls Pre-Tour  
Extension (2026)

**[See Details](#)**

## Accommodation

### Palacio Duhau - Park Hyatt Buenos Aires



Palacio Duhau is a superb city hotel and a member of the legendary Park Hyatt portfolio. The building itself is hugely impressive. The exterior retains the wonderful belle-époque architecture of the 1932 French Palace Duhau, whilst the interior is all sleek design and modern décor.

Its stylish, spacious rooms and exclusive suites have street or garden views and are immaculately presented, with modern décor offering a backdrop for the latest technology and luxurious furnishings. All have plush king sized beds, oversized work desks and majestic bathrooms with tub and rain shower. Luxurious touches include Celedonio Lohido-designed spa products, 30-inch flat-screen TVs and butler service.

#### Why we like it

- The rooms and suites are spacious and packed with luxurious touches
- Palacio Duhau is in an ideal central location on Avenida Alvear
- Dining options include the signature Duhau Restaurant and, for something special, the Vinoteca & Cheese Room, which offers fine Argentinian Malbecs and regional cheeses selected by the Maître Fromager
- The Ahin Spa can only be described as 'sumptuous'
- A beautiful, short-course indoor heated swimming pool is located in the spa

## Le Lyrial



An A&K voyage to Antarctica offers the opportunity to experience the world's most pristine region at its very best on board the comfortable and sophisticated Le Lyrial. Enjoy its stunning blue palette inspired by the Vega star, all-balcony staterooms and suites, and the finest expedition staff cruising the southern ocean today.

On other cruises to different destinations, she carries more than 264 passengers: on voyages with A&K, we limit her capacity to just 199 clients. Fewer passengers in turn allows for more shore excursions each day and cabins with private balconies for every guest.

Relax in the on-board spa and hammam or take a dip in the outdoor heated saltwater pool with panoramic ocean views to the horizon.

The two on-board restaurants offer a selection of gourmet and international cuisine while the airy and elegant communal areas provide the perfect mix of quiet corners and sociable spaces. By day, enjoy a series of enriching lectures by leading experts about your natural surroundings. Then by night, the Club Lounge and the Theatre take care of your evening's entertainment with a variety of live music shows and film screenings.

### Amenities

- All outside staterooms and suites offer a private balcony when chartered by A&K
- Complimentary butler service for Deck 6, categories 4-9
- Sun deck and multiple outer deck observation areas
- Outside heated saltwater pool
- Library with extensive selection of books and reading areas
- Panoramic lounge and terrace

- Three bars and a boutique
- Fitness centre with state-of-the-art equipment
- Hairdresser offering full-service hair styling, manicures and pedicures
- Spa and hammam (steam room)
- On-board medical facilities with certified doctor
- 24-hour room service and laundry services
- The Club lounge hosts live music and dancing
- The Theatre offers unobstructed-view seating for live performances and film screenings
- Wireless internet access throughout the ship
- Dynamic positioning system

### **Strength and Style**

- Sophisticated design, innovative marine technology and a convenient layout aided by three passenger elevators are among 'Le Lyrial's' many features.
- On A&K voyages, we limit her capacity to just 199 guests, allowing for more shore excursions each day and cabins with private balconies for every guest.

### **Safety**

- Safety is first and foremost on board sturdy 'Le Lyrial.'
- The ship features the latest communication, navigational and safety equipment.
- A&K's English-speaking staff is readily available to assist and instruct on safety at all times during your cruise.

### **Environmentally Sound Operations**

- In keeping with A&K's longstanding commitment to environmental conservation, 'Le Lyrial' is equipped with the most eco-friendly technology available today.
- Our expeditions exceed all environmental protocols, including those set by the National Science Foundation, Environmental Protection Agency and Antarctic Treaty Party nations.

### **Rest and Relaxation Redefined**

- Among the most comfortable available on any polar expedition ship, all 108 cabins are fully equipped and feature bedding configurations that range from king-size beds to two single beds.
- Premier and Privilege Two-Room Suites feature a sofa that converts to a fixed queen-size bed, and the option to convert into a two-room cabin - perfect for families. 'Le Lyrial' also offers an additional Grand Deluxe Suite.
- 'Le Lyrial' is outfitted with a technologically advanced stabilizing system to minimize the effects of rough conditions and help keep passengers comfortable at all times.

### **Space to Meet and Mingle**

- Spacious and elegant, 'Le Lyrial's' common areas invite casual conversation with fellow

guests as well as private reflection and views in quiet corners.

- The Panoramic Lounge and Terrace offer spacious areas ideal for social gatherings, afternoon tea or just relaxing with ocean views.
- The Club offers an elegant atmosphere in the evening, with live music and dancing, while the Theatre is the ideal venue for nightly entertainment, enrichment lectures and movies.

### International Cuisine

- The Restaurant offers gourmet and international cuisine while The Compass Grill delivers casual indoor and outdoor dining for breakfast, lunch and themed dinners.
- There is always a selection of light fare and vegetarian dishes, and most special diets can be accommodated with advance notice.
- In-cabin room service is available 24/7.

### Personal Butler Service on Board

- Cabin Categories 4-9 on Deck 6 receive the complimentary services of a private butler.
- From ensuring your suite is up to your standards to organizing cocktails on your private balcony, your butler tends to your every need, with grace and efficiency.

## 'Le Lyrial'

- Category 1  
Classic Stateroom
- Category 2  
Deluxe Stateroom
- Category 3  
Premier Stateroom
- Category 4\*  
Prestige Suite
- Category 5\*  
Premier Two-Room Suite
- Category 6\*  
Privilege Two-Room Suite
- Category 7\*  
Grand Deluxe Two-Room Suite
- Category 8\*  
Grand Privilege Three-Room Suite
- Category 9\*  
Owner's Suite

\*Butler Service Included

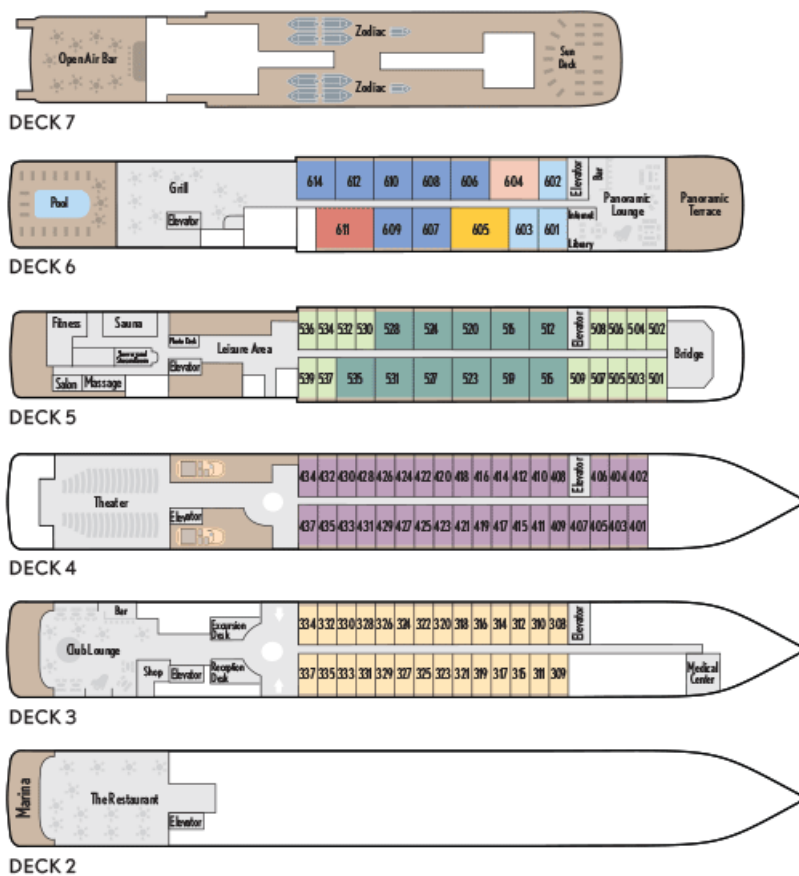

BUTLER SERVICE INCLUDED



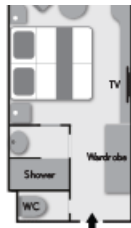

Categories 1-3  
Staterooms  
Cabin: 18sq. mt. | Balcony: 4sq. mt.



Category 4  
Prestige Suite  
Cabin: 27 sq. mt. | Balcony: 6 sq. mt.

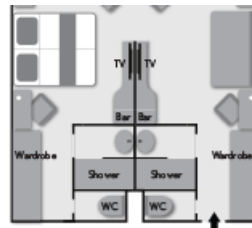

Category 5  
Premier Two-Room Suite  
Cabin: 36 sq. mt. | Balcony: 8 sq. mt.

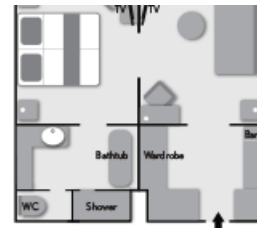

Category 6  
Privilege Two-Room Suite  
Cabin: 36 sq. mt. | Balcony: 8 sq. mt.

BUTLER SERVICE INCLUDED

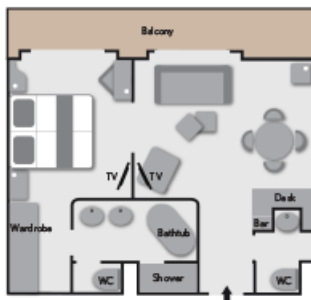

Category 7  
Grand Deluxe Two-Room Suite  
Cabin: 45 sq. mt. | Balcony: 10 sq. mt.

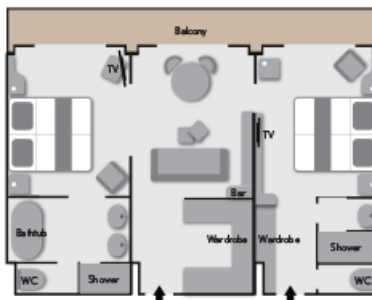

Category 8  
Grand Privilege Three-Room Suite  
Cabin: 54 sq. mt. | Balcony: 12 sq. mt.

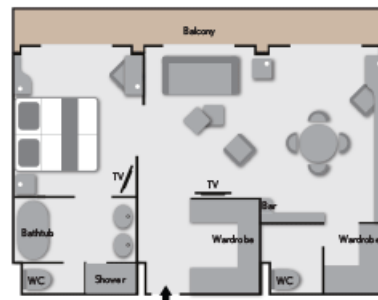

Category 9  
Owner's Suite  
Cabin: 54 sq. mt. | Balcony: 12 sq. mt.

## Dates & Pricing

Prices are in AUD, per person, based on double occupancy

### Jan 7, 2026 - Jan 25, 2026

Cabin Class	Price	Single Supplement	Internal Air (From)	Availability
Le Lyrial: Classic Balcony Stateroom - Category 1	<b>AU\$39,790 pp</b>	AU\$9,940	Included	Call for Availability
Cabin Class	Price	Single Supplement	Internal Air (From)	Availability
Le Lyrial: Deluxe Balcony Stateroom - Category 2	<b>AU\$45,150 pp</b>	AU\$11,290	Included	Call for Availability
Cabin Class	Price	Single Supplement	Internal Air (From)	Availability
Le Lyrial: Premier Balcony Stateroom - Category 3	<b>AU\$48,210 pp</b>	AU\$12,055	Included	Call for Availability
Cabin Class	Price	Single Supplement	Internal Air (From)	Availability
Le Lyrial: Prestige Balcony Suite - Category 4	<b>AU\$68,875 pp</b>	AU\$51,655	Included	Call for Availability
Cabin Class	Price	Single Supplement	Internal Air (From)	Availability
Le Lyrial: Premier Two-Room Balcony Suite - Category 5	<b>AU\$82,650 pp</b>	AU\$61,985	Included	Call for Availability
Cabin Class	Price	Single Supplement	Internal Air (From)	Availability
Le Lyrial: Privilege Two-Room Balcony Suite - Category 6	<b>AU\$88,005 pp</b>	AU\$66,010	Included	Call for Availability
Cabin Class	Price	Single Supplement	Internal Air (From)	Availability
Le Lyrial: Grand Deluxe Two-Room Balcony Suite - Category 7	<b>AU\$94,895 pp</b>	AU\$71,170	Included	Call for Availability
Cabin Class	Price	Single Supplement	Internal Air (From)	Availability
Le Lyrial: Grand Privilege Three-Room Balcony Suite - Category 8	<b>AU\$109,435 pp</b>	AU\$82,085	Included	Call for Availability
Cabin Class	Price	Single Supplement	Internal Air (From)	Availability
Le Lyrial: Owner's Balcony Suite - Category 9	<b>AU\$113,265 pp</b>	AU\$107,600	Included	Call for Availability

# Abercrombie & Kent

**Call Us Now on  
1300 851 924  
within Australia**

Melbourne Office:

T: +61 (0)3 9536 1800

F: +61 (0) 3 9536 1805

E: [contact@abercrombiekent.com.au](mailto:contact@abercrombiekent.com.au)

Address

Level 26 (North Tower)

80 Collins St

Melbourne, VIC, 3000

International:

New Zealand Call: 0800 441 638

Asia Call: 800 4747 7700