



ARCTIC CRUISE ADVENTURE: IN SEARCH OF THE POLAR BEAR (2025)

Discover geological wonders and see the majestic polar bear in its natural environment on a voyage to magnificent Arctic islands.

Cruises, A&K Luxury Expedition Cruises



Arctic, Norway, Iceland



15 days from AU\$35,200 pp



199 Guests

Journey Overview



Chairman's Cruise with Manfredi Lefebvre d'Ovidio

Set sail for the Arctic with a true luminary of travel, Manfredi Lefebvre d'Ovidio, Executive Chairman of AK Travel Group, who travels with you in Svalbard, to the land of the mighty polar bear. Travel alongside A&K's unmatched Expedition Team and engaging experts as you seek out the sea bear in the Svalbard Islands, marvel at east Greenland's majestic fjords, and discover the starkly beautiful lava fields and waterfalls of Iceland's Westfjords. Reserve your space and look forward to a voyage of epic wildernesses and unforgettable adventure on our Chairman's Cruise.

Journey Highlights

- Cruise the Arctic's wildest regions for 13 nights aboard exclusively chartered Le Lyrial, enjoying a capacity limited to just 199 guests
- Enjoy active exploration of the Arctic's varied landscapes, from Zodiac excursions through ice floes to epic volcanic hikes, all under the wing of A&K's acclaimed Expedition Team
- Experience a vast breadth of Arctic wildlife habitats, including the polar bear haven of Svalbard
- Cruise to the remote east coast of Greenland, where you may visit Scoresby Sound and the Inuit village of Ittoqqortoormiit
- Discover North Iceland and the whale-watching port of Husavik, where you experience a private, behind-the-scenes tour at the renowned Husavik Whale Museum
- Join photography lectures, hands-on workshops and tips in the field led by A&K's dedicated photo coach



Itinerary

Jul 25: Arrive Oslo, Norway

Arrive in Oslo, your gateway to the Arctic. Upon arrival, you are met and escorted to the conveniently located Radisson Blu Airport Hotel. This evening, gather for a welcome briefing and dinner.

Radisson Blu Airport Hotel, Oslo Gardermoen | Meals: D

Jul 26: Longyearbyen | Gateway to Adventure

Board your charter flight to Longyearbyen, the capital of Svalbard, also known as Spitsbergen, the sovereign Arctic Archipelago of Norway. It is one of the most remote groups of islands on the planet, with nearly two-thirds of its surface covered in luminous glaciers. This afternoon, board your luxury expedition cruiser.

Le Lyréal | Meals: BLD

Jul 27: Svalbard Islands | Northern Outpost

Awake to your first morning aboard as your vessel cruises up the Svalbard coast. Today's explorations may feature Ny-Alesund, home to a polar research station and the northernmost post office in the world. Back aboard, enjoy a welcome dinner hosted by the Captain.

Le Lyréal | Meals: BLD

Jul 28: Svalbard Islands | Glacial Archipelago

Today, your vessel sets course for Monacobreen. Formerly known as Monaco Bay, this glacier reaches down into Spitsbergen and is frequented by polar bears, harbour and bearded seals, walrus and a multitude of seabirds. You may also cruise through Liefdefjorden (The Love Fjord), another excellent area for spotting polar bears.

Le Lyréal | Meals: BLD

Jul 29: Svalbard Islands | Realm of the Polar Bear

Conditions permitting, you may set out on a Zodiac excursion along steep cliffs harbouring vast colonies of auk diving birds. This afternoon, your Captain and Expedition Team may take advantage of sea conditions and arrange an invigorating and scenic hike ashore.

Le Lyrial | Meals: BLD

Jul 30: Svalbard Islands | Majestic Scenery

Your expedition continues northward as you take in breathtaking mountains, glaciers and icebergs and keep watch for polar bears, Brünnich's guillemots and numerous species of kittiwakes.

Le Lyrial | Meals: BLD

Jul 31: Svalbard Islands | Tip of the Archipelago

The day's explorations may take you to the most northerly region of the Svalbard Islands.

Le Lyrial | Meals: BLD

Aug 1: At Sea | Cruising the Greenland Sea

Cruise south through the Greenland Sea as your Expedition Team lectures on the wildlife, history and geology of the Svalbard Islands.

Le Lyrial | Meals: BLD

Aug 2: Jan Mayen | Glacier-Cloaked Volcano

The day's planned shore excursion is Jan Mayen, a rugged island dominated by the 2,286 metre Beerenberg Volcano, the world's northernmost active volcano. With special permission and conditions permitting, land on this rarely visited island to see its meteorological station and discover colonies of northern fulma, little auk, thick-billed guillemot and black guillemot.

Le Lyrial | Meals: BLD

Aug 3: Ittoqqortoormiit, Greenland | Remote Village

Today, ice conditions permitting, disembark for a visit to the small settlement of Ittoqqortoormiit, one of the most isolated villages in Greenland.

Le Lyrial | Meals: BLD

Aug 4: Scoresby Sound | Endless Fjords

Your Captain charts a course across the Greenland Sea, skirting the Arctic ice edge toward Greenland's rarely visited eastern coast and Scoresby Sound, the largest and longest fjord system in the world. You may embark on Zodiac excursions through the fjord's intricate network, taking in its islands and icebergs while searching for Arctic and musk fox.

Le Lyrical | Meals: BLD

Aug 5: At Sea | Cruising the Denmark Strait

Cruise the Denmark Strait as you relax or watch for seabirds and whale from the deck between insightful lectures from your Expedition Team.

Le Lyrical | Meals: BLD

Aug 6: Husavik, Iceland | Whale-Watching Haven

Today, opt to visit picturesque Husavik and its fascinating whale museum. Supported by A&K Philanthropy, the museum is one of the world's foremost whale research centres. Alternatively, choose to embark on a scenic whale-watching tour, or perhaps set off for Godafoss Falls and geothermal Lake Myvatn. Tonight, gather for a special farewell reception and dinner.

Le Lyrical | Meals: BLD

Aug 7: Iceland's Westfjords | Lava & Ice-Carved Lands

Explore the Westfjords of Iceland, a remote region of small settlements interspersed amid spectacular mountains and coves. Here, take in the stunning views as you enjoy a leisurely walk or embark on a more vigorous trek ashore.

Le Lyrical | Meals: BLD

Aug 8: Depart Reykjavik

This morning, disembark your expedition cruiser in Reykjavik and transfer to the airport for your onward departure or discover more of Iceland on the post-tour extension.

Meals: B

Journey Details

This journey contains some active elements, including Zodiac boat excursions, walks over uneven terrain and optional, challenging hikes.

Minimum age is 7 years.

Categories 5–8 include room upgrade at the hotel and butler service aboard the ship.

First group event: welcome briefing at 6:30 p.m. on Jul 25.

Last group event: disembarkation by 9:00 a.m. on Aug 8.

Note: Itinerary may be adjusted at the sole discretion of the Captain due to weather, wildlife, sea and ice conditions, medical emergencies and unforeseen circumstances beyond A&K's control.

Included with this Luxury Expedition Cruise

- An Exclusively Chartered, All-Inclusive Voyage Led by A&K's Expedition Team
- Pre- and/or Post-Cruise Stay at Ideally Located Hotel
- Airport Meet and Greet and Transfers
- Private Balcony with Every Onboard Accommodation and Butler Service with Every Suite
- Maximum Personnel-to-Guest Ratio of 1 to 1.2
- Culinary Program Featuring French-Inspired Cuisine, Including House Drinks, Afternoon Tea and Pastries
- 24-Hour Room Service and Breakfast in Bed on board
- Complimentary Expedition Parka, Backpack and Water Bottle, and Use of Waterproof Pants, Boots and Trekking Poles
- Zodiac Excursions Led by Expert Naturalist Driver-Guides
- Enrichment program, lectures and presentations
- Traveller's Valet® Laundry Service on board
- All Gratuities, Port Charges and Taxes
- Complimentary Wi-Fi on Board and in Hotels
- Onboard Service from an English-Speaking Staff, Including an Accredited Physician
- 24/7 A&K On-Call Support

Map



Extensions



Oslo Pre-Tour Extension
(2025)

[**See Details**](#)



Reykjavik Post-Tour
Extension (2025)

[**See Details**](#)

Accommodation

Hotel Radisson Blu Gardermoen, Oslo



Linked to the Oslo Airport, Gardermoen (OSL) terminal by a covered walkway, the Radisson Blu Airport Hotel is just steps from bus and train stations. You can reach the vibrant city centre in about 20 minutes via Flytoget, the Airport Express train.

Each of the 500 rooms and suites include convenient amenities such as free high-speed wireless internet and soundproof windows for a restful stay. Rooms feature New Scandinavian, Chili and Naturally Cool design themes that lend a cosy atmosphere. Offering wheelchair-accessible and hypoallergenic rooms upon request.

The new and modern 26 North Restaurant & Social Club, is inspired by the Nordic countries, their nature, culinary treasures and design. The Lobby Lounge offers an inviting atmosphere where you can relax with a coffee or a drink. Keep up with your fitness regimen at the Fit4Flight wellness centre.

The hotel offers new, modern Meeting & Events facilities. The hotel's location makes it the perfect accommodation to explore the Norwegian Capital. A short train ride takes you to the city centre, ready to discover popular attractions such as the Vigeland Park and Museum, the Opera House and the Astrup Fearnley Museum. The latter is right next to the Sneak Peak watchtower, which offers a panoramic view of Aker Brygge

(the old wharf), Oslo City Hall and the Harbor.

Why we like it:

- The soundproof rooms and suites include amenities such as minibars and free high-speed wireless Internet.
- Several on-site dining options to discover the flavours of the North
- The perfect location to explore the numerous attractions in Oslo and to experience the Scandinavian lifestyle.

Le Lyrial



An A&K voyage to Antarctica offers the opportunity to experience the world's most pristine region at its very best on board the comfortable and sophisticated Le Lyrial. Enjoy its stunning blue palette inspired by the Vega star, all-balcony staterooms and suites, and the finest expedition staff cruising the southern ocean today.

On other cruises to different destinations, she carries more than 264 passengers: on voyages with A&K, we limit her capacity to just 199 clients. Fewer passengers in turn allows for more shore excursions each day and cabins with private balconies for every guest.

Relax in the on-board spa and hammam or take a dip in the outdoor heated saltwater pool with panoramic ocean views to the horizon.

The two on-board restaurants offer a selection of gourmet and international cuisine while the airy and elegant communal areas provide the perfect mix of quiet corners and sociable spaces. By day, enjoy a series of enriching lectures by leading experts about your natural surroundings. Then by night, the Club Lounge and the Theatre take care of your evening's entertainment with a variety of live music shows and film screenings.

Amenities

- All outside staterooms and suites offer a private balcony when chartered by A&K
- Complimentary butler service for Deck 6, categories 4-9
- Sun deck and multiple outer deck observation areas
- Outside heated saltwater pool
- Library with extensive selection of books and reading areas
- Panoramic lounge and terrace

- Three bars and a boutique
- Fitness centre with state-of-the-art equipment
- Hairdresser offering full-service hair styling, manicures and pedicures
- Spa and hammam (steam room)
- On-board medical facilities with certified doctor
- 24-hour room service and laundry services
- The Club lounge hosts live music and dancing
- The Theatre offers unobstructed-view seating for live performances and film screenings
- Wireless internet access throughout the ship
- Dynamic positioning system

Strength and Style

- Sophisticated design, innovative marine technology and a convenient layout aided by three passenger elevators are among 'Le Lyrial's' many features.
- On A&K voyages, we limit her capacity to just 199 guests, allowing for more shore excursions each day and cabins with private balconies for every guest.

Safety

- Safety is first and foremost on board sturdy 'Le Lyrial.'
- The ship features the latest communication, navigational and safety equipment.
- A&K's English-speaking staff is readily available to assist and instruct on safety at all times during your cruise.

Environmentally Sound Operations

- In keeping with A&K's longstanding commitment to environmental conservation, 'Le Lyrial' is equipped with the most eco-friendly technology available today.
- Our expeditions exceed all environmental protocols, including those set by the National Science Foundation, Environmental Protection Agency and Antarctic Treaty Party nations.

Rest and Relaxation Redefined

- Among the most comfortable available on any polar expedition ship, all 108 cabins are fully equipped and feature bedding configurations that range from king-size beds to two single beds.
- Premier and Privilege Two-Room Suites feature a sofa that converts to a fixed queen-size bed, and the option to convert into a two-room cabin - perfect for families. 'Le Lyrial' also offers an additional Grand Deluxe Suite.
- 'Le Lyrial' is outfitted with a technologically advanced stabilizing system to minimize the effects of rough conditions and help keep passengers comfortable at all times.

Space to Meet and Mingle

- Spacious and elegant, 'Le Lyrial's' common areas invite casual conversation with fellow

guests as well as private reflection and views in quiet corners.

- The Panoramic Lounge and Terrace offer spacious areas ideal for social gatherings, afternoon tea or just relaxing with ocean views.
- The Club offers an elegant atmosphere in the evening, with live music and dancing, while the Theatre is the ideal venue for nightly entertainment, enrichment lectures and movies.

International Cuisine

- The Restaurant offers gourmet and international cuisine while The Compass Grill delivers casual indoor and outdoor dining for breakfast, lunch and themed dinners.
- There is always a selection of light fare and vegetarian dishes, and most special diets can be accommodated with advance notice.
- In-cabin room service is available 24/7.

Personal Butler Service on Board

- Cabin Categories 4-9 on Deck 6 receive the complimentary services of a private butler.
- From ensuring your suite is up to your standards to organizing cocktails on your private balcony, your butler tends to your every need, with grace and efficiency.

'Le Lyrial'

- Category 1
Classic Stateroom
- Category 2
Deluxe Stateroom
- Category 3
Premier Stateroom
- Category 4*
Prestige Suite
- Category 5*
Premier Two-Room Suite
- Category 6*
Privilege Two-Room Suite
- Category 7*
Grand Deluxe Two-Room Suite
- Category 8*
Grand Privilege Three-Room Suite
- Category 9*
Owner's Suite

*Butler Service Included

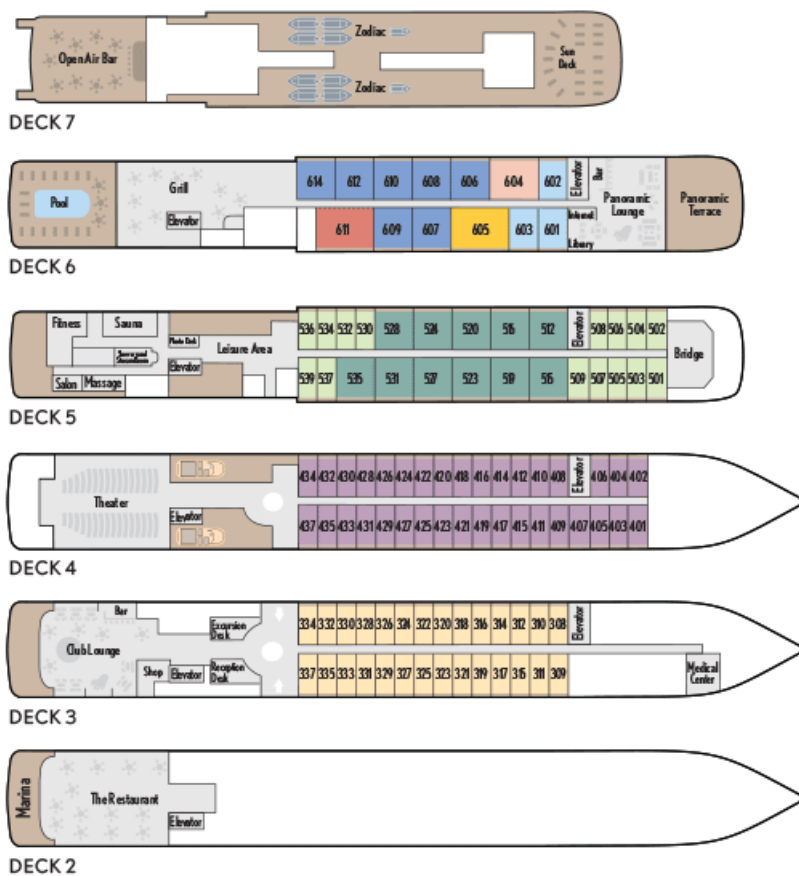

BUTLER SERVICE INCLUDED



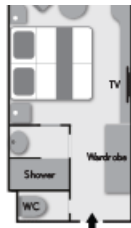

Categories 1-3
Staterooms
Cabin: 18 sq. mt. | Balcony: 4 sq. mt.



Category 4
Prestige Suite
Cabin: 27 sq. mt. | Balcony: 6 sq. mt.

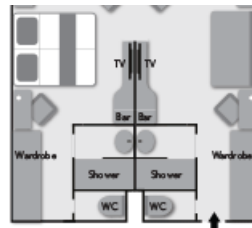

Category 5
Premier Two-Room Suite
Cabin: 36 sq. mt. | Balcony: 8 sq. mt.

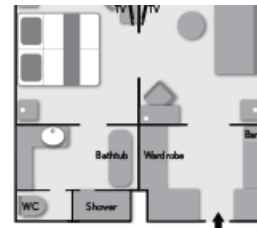

Category 6
Privilege Two-Room Suite
Cabin: 36 sq. mt. | Balcony: 8 sq. mt.

BUTLER SERVICE INCLUDED

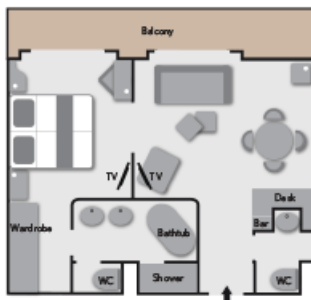

Category 7
Grand Deluxe Two-Room Suite
Cabin: 45 sq. mt. | Balcony: 10 sq. mt.

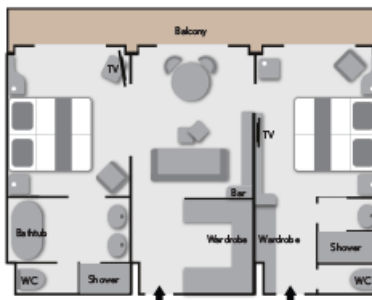

Category 8
Grand Privilege Three-Room Suite
Cabin: 54 sq. mt. | Balcony: 12 sq. mt.

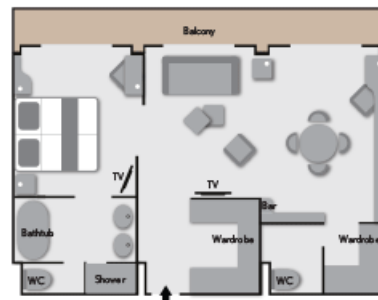

Category 9
Owner's Suite
Cabin: 54 sq. mt. | Balcony: 12 sq. mt.

Dates & Pricing

Prices are in AUD, per person, based on double occupancy

Jul 25, 2025 - Aug 8, 2025

| | | | | |
|--|----------------------|-------------------|---------------------|-----------------------|
| Cabin Class | Price | Single Supplement | Internal Air (From) | Availability |
| Le Lyrial: Classic Balcony Stateroom - Category 1 | AU\$35,200 pp | AU\$8,870 | AU\$0 | Call for Availability |
| Cabin Class | Price | Single Supplement | Internal Air (From) | Availability |
| Le Lyrial: Deluxe Balcony Stateroom - Category 2 | AU\$39,025 pp | AU\$9,790 | AU\$0 | Call for Availability |
| Cabin Class | Price | Single Supplement | Internal Air (From) | Availability |
| Le Lyrial: Premier Balcony Stateroom - Category 3 | AU\$42,085 pp | AU\$10,555 | AU\$0 | Call for Availability |
| Cabin Class | Price | Single Supplement | Internal Air (From) | Availability |
| Le Lyrial: Prestige Balcony Suite - Category 4 | AU\$46,680 pp | AU\$35,045 | AU\$0 | Call for Availability |
| Cabin Class | Price | Single Supplement | Internal Air (From) | Availability |
| Le Lyrial: Premier Two-Room Balcony Suite - Category 5 | AU\$61,220 pp | AU\$45,915 | AU\$0 | Call for Availability |
| Cabin Class | Price | Single Supplement | Internal Air (From) | Availability |
| Le Lyrial: Privilege Two-Room Balcony Suite - Category 6 | AU\$73,465 pp | AU\$55,095 | AU\$0 | Call for Availability |
| Cabin Class | Price | Single Supplement | Internal Air (From) | Availability |
| Le Lyrial: Grand Deluxe Two-Room Balcony Suite - Category 7 | AU\$78,060 pp | AU\$58,620 | AU\$0 | Call for Availability |
| Cabin Class | Price | Single Supplement | Internal Air (From) | Availability |
| Le Lyrial: Grand Privilege Three-Room Balcony Suite - Category 8 | AU\$87,240 pp | AU\$65,505 | AU\$0 | Call for Availability |
| Cabin Class | Price | Single Supplement | Internal Air (From) | Availability |
| Le Lyrial: Owner's Balcony Suite - Category 9 | AU\$94,130 pp | AU\$89,540 | AU\$0 | Call for Availability |

Abercrombie & Kent

**Call Us Now on
1300 851 924
within Australia**

Melbourne Office:

T: +61 (0)3 9536 1800

F: +61 (0) 3 9536 1805

E: contact@abercrombiekent.com.au

Address

Level 26 (North Tower)

80 Collins St

Melbourne, VIC, 3000

International:

New Zealand Call: 0800 441 638

Asia Call: 800 4747 7700