

Abercrombie & Kent



ANTARCTICA, SOUTH GEORGIA & FALKLANDS: HOLIDAY VOYAGE (2024)

Experience an epic holiday adventure to
Antarctica, South Georgia and the Falkland
Islands with special family programming.

Cruises, A&K Luxury Expedition Cruises



Antarctica



19 days from AU\$36,145 pp



199 Guests

Journey Overview

Experience an epic holiday adventure to Antarctica, South Georgia and the Falkland Islands, celebrating the arrival of the new year in the world's most remarkable wilderness alongside A&K's passionate Expedition Team. Enjoy additional family programming led by A&K Young Explorers Guides and unforgettable holiday festivities on board, all while experiencing otherworldly landscapes on Zodiac excursions.

Journey Highlights

- Cruise for 16 nights on an extended holiday voyage to Antarctica, South Georgia and the Falkland Islands, onboard a luxurious mega-yacht exclusively chartered by A&K
- Voyage to the Falkland Islands to explore this remote archipelago's colourful history and wildlife
- Explore historic, wildlife-rich South Georgia, where you visit spectacular king penguin colonies as well as the gravesite of one of Antarctica's most intrepid explorers, Sir Ernest Shackleton
- Celebrate an unforgettable Christmas and New Year's Eve with spirited onboard festivities while exploring the Southern Ocean
- Young guests enjoy additional family programming led by dedicated Young Explorers Guides
- Begin your adventure with a two-night stay in Buenos Aires, exploring this fiery Latin city with your choice of shore excursion

Take 10 with an A&K Expert to Hear More About This Journey



Itinerary

Dec 20: Arrive Buenos Aires, Argentina

Upon arrival in Argentina's capital, you are met and transferred to the Palacio Duhau — Park Hyatt Buenos Aires.

Palacio Duhau | Park Hyatt Buenos Aires

Dec 21: Buenos Aires | A Vibrant Capital Revealed

Explore Buenos Aires, a dynamic city known for its diverse architecture and vibrant contemporary arts scene. Take in a guided tour and tango demonstration or delve into the city's colourful street art culture. In the evening, gather for a welcome cocktail reception.

Palacio Duhau | Park Hyatt Buenos Aires | Meals: B

Dec 22: Ushuaia | Cast Off on Your Family Adventure

Fly to Ushuaia, your gateway to Antarctica. Here, you might opt for a trek in the Cerro Alarkén Nature Reserve before boarding your vessel and cruising out to sea.

'Le Lyrial' | Meals: BLD

Dec 23: The South Atlantic | Welcome Aboard

Awake to your first morning aboard. Today, cruise east toward the Falkland Islands while A&K's Expedition Team begins its lecture series, and the Young Explorers Guides entertain with a host of onboard activities.

'Le Lyrial' | Meals: BLD

Dec 24: The Falkland Islands | Historic Outpost

Today, your Captain may set a course for the remote Falkland Islands, a starkly beautiful sub-Antarctic enclave harbouring a wealth of marine and bird life. Here, you may spot gentoo or rockhopper penguin, or majestic albatross.

'Le Lyrial' | Meals: BLD

Dec 25: The Falkland Islands | A Holiday Celebration

Experience a Christmas Day like no other as you continue your exploration of the Falkland Islands region. Conditions permitting, you may visit the historic capital of Stanley or explore its surrounding wilderness areas. This evening, partake in memorable holiday festivities as your vessel is scheduled to sail toward South Georgia.

'Le Lyrial' | Meals: BLD

Dec 26: The South Atlantic | Cruising to South Georgia

Today, your planned course continues toward South Georgia. Time aboard is once again filled with fascinating lectures by your Expedition Team as well as exciting family-friendly programming led by Young Explorers Guides.

'Le Lyrial' | Meals: BLD

Dec 27: The South Atlantic | Sightings at Sea

As you approach South Georgia, deckside wildlife sightings may become more frequent. This stretch of ocean is a treasure chest bursting with life. Scan for seabirds as you keep an eye out for remote islets like the six distinctively pointed outcroppings of the Shag Rocks.

'Le Lyrial' | Meals: BLD

Dec 28: South Georgia | Wildlife Haven

The day's planned destination is South Georgia, one of the Southern Ocean's most biodiverse regions. Weather permitting, explore its glacier-carved coves and rugged shores, searching for vast colonies of king penguin, as well as southern elephant seal and fur seal.

'Le Lyrial' | Meals: BLD

Dec 29: South Georgia | Legendary Footsteps

Today, you might explore sites with your A&K historian as they share tales of the whaling era and the exploits of legendary explorer Sir Ernest Shackleton.

'Le Lyrial' | Meals: BLD

Dec 30: South Georgia | Photographer's Paradise

A photographer's paradise, beguiling South Georgia invites you to take your best shot. Conditions permitting, you may visit Gold Harbour, a vital habitat populated with fur seal, southern elephant seal and king penguin.

'Le Lyrial' | Meals: BLD

Dec 31: The Scotia Sea | New Year's Eve Celebration at Sea

Today's planned course plies the Scotia Sea. As the end of the year approaches, celebrate with onboard festivities and the anticipation of Antarctica.

'Le Lyrial' | Meals: BLD

Jan 1: The Scotia Sea | Antarctic Anticipation

Awake to a New Year's Day unlike any other as your Expedition Team ushers in tomorrow's planned landing on the Antarctic continent.

'Le Lyrial' | Meals: BLD

Jan 2: Antarctica | Incredible White Continent

Weather and ice conditions permitting, your Expedition Team takes advantage of the best opportunities for landings on the Antarctic Peninsula and the South Shetland Islands in search of gentoo and chinstrap penguin.

'Le Lyrial' | Meals: BLD

Jan 3: Antarctica | The Ride of a Lifetime

If the weather holds, younger guests may get a turn at the tiller of a nimble Zodiac boat. In the evening, capture photos in the stunning Antarctic twilight.

'Le Lyrial' | Meals: BLD

Jan 4: Antarctica | Wondrous Wilderness

Antarctica invites another day of adventure as snow-capped mountains, shimmering glaciers and iceberg-strewn channels compete for your attention.

'Le Lyrial' | Meals: BLD

Jan 5: The Drake Passage | A Parting Glimpse

Today, bid farewell to Antarctica as your vessel returns north toward Ushuaia and the Young Explorers enjoy activities with their dedicated guides.

'Le Lyrial' | Meals: BLD

Jan 6: The Drake Passage | Reflections at Sea

While cruising this historic passage, keep an eye out for the giant petrel and the elusive albatross.

'Le Lyrial' | Meals: BLD

Jan 7: Depart Ushuaia

After your scheduled arrival in Ushuaia, disembark and transfer to your connecting flight to Buenos Aires.

Meals: B

Journey Details:

Note: Itinerary is for guidance purposes only and may be adjusted due to unforeseen circumstances including weather, wildlife, ice, medical emergencies and other conditions beyond A&K's control at the sole discretion of the Captain.

This journey contains some active elements, including Zodiac boat excursions, walks over uneven terrain and optional, challenging hikes.

Buenos Aires/Ushuaia/Buenos Aires Economy Class flights included.

Minimum age is 7 years.

Categories 4-9 include room upgrade at the hotel and butler service aboard the ship.

First group event: excursion on Dec 21.

Last group event: disembarkation by 9:00 a.m. on Jan 7.

Special Family Pricing: Children 7-18 years old in categories 1-3, 5-6 and 8. Ask about triple and quad pricing available in categories 5, 6 and 8.

Included with this Luxury Expedition Cruise

- An Exclusively Chartered, All-Inclusive Voyage Led by A&K's Expedition Team
- Pre-Cruise Stay at Stylish, Ideally Located Hotel and A&K-Led Excursion
- Airport Meet and Greet and Transfers
- Private Balcony with Every Onboard Accommodation and Butler Service with Every Suite
- Maximum Personnel-to-Guest Ratio of 1 to 1.3 and ship occupancy limited to 80 percent
- Culinary Program Featuring French-Inspired Cuisine, Including House Drinks, Afternoon Tea and Pastries
- 24-Hour Room Service and Breakfast in Bed on board
- Complimentary Expedition Parka, Backpack and Water Bottle, and Use of Waterproof Pants, Boots and Trekking Poles
- Zodiac Excursions Led by A&K Expert Naturalist Driver-Guides
- Traveller's Valet Laundry Service on board
- All Gratuities, Port Charges and Taxes
- Complimentary Wi-Fi on Board and in Hotels
- Onboard Service from an English-Speaking Staff, Including an Accredited Physician
- 24/7 A&K On-Call Support

Map



Extensions



Iguazu Falls Pre-Tour
Extension (2024)

See Details

Accommodation

Le Lyrial



An A&K voyage to Antarctica offers the opportunity to experience the world's most pristine region at its very best on board the comfortable and sophisticated Le Lyrial. Enjoy its stunning blue palette inspired by the Vega star, all-balcony staterooms and suites, and the finest expedition staff cruising the southern ocean today.

On other cruises to different destinations, she carries more than 264 passengers: on voyages with A&K, we limit her capacity to just 199 clients. Fewer passengers in turn allows for more shore excursions each day and cabins with private balconies for every guest.

Relax in the on-board spa and hammam or take a dip in the outdoor heated saltwater pool with panoramic ocean views to the horizon.

The two on-board restaurants offer a selection of gourmet and international cuisine while the airy and elegant communal areas provide the perfect mix of quiet corners and sociable spaces. By day, enjoy a series of enriching lectures by leading experts about your natural surroundings. Then by night, the Club Lounge and the Theatre take care of your evening's entertainment with a variety of live music shows and film screenings.

Amenities

- All outside staterooms and suites offer a private balcony when chartered by A&K
- Complimentary butler service for Deck 6, categories 4-9
- Sun deck and multiple outer deck observation areas
- Outside heated saltwater pool
- Library with extensive selection of books and reading areas
- Panoramic lounge and terrace
- Three bars and a boutique
- Fitness centre with state-of-the-art equipment
- Hairdresser offering full-service hair styling, manicures and pedicures
- Spa and hammam (steam room)
- On-board medical facilities with certified doctor
- 24-hour room service and laundry services
- The Club lounge hosts live music and dancing
- The Theatre offers unobstructed-view seating for live performances and film screenings
- Wireless internet access throughout the ship
- Dynamic positioning system

Strength and Style

- Sophisticated design, innovative marine technology and a convenient layout aided by three passenger elevators are among 'Le Lyrial's' many features.
- On A&K voyages, we limit her capacity to just 199 guests, allowing for more shore excursions each day and cabins with private balconies for every guest.

Safety

- Safety is first and foremost on board sturdy 'Le Lyrial.'
- The ship features the latest communication, navigational and safety equipment.
- A&K's English-speaking staff is readily available to assist and instruct on safety at all times during your cruise.

Environmentally Sound Operations

- In keeping with A&K's longstanding commitment to environmental conservation, 'Le Lyrial' is equipped with the most eco-friendly technology available today.
- Our expeditions exceed all environmental protocols, including those set by the National Science Foundation, Environmental Protection Agency and Antarctic Treaty Party nations.

Rest and Relaxation Redefined

- Among the most comfortable available on any polar expedition ship, all 108 cabins are fully equipped and feature bedding configurations that range from king-size beds to two single beds.
- Premier and Privilege Two-Room Suites feature a sofa that converts to a fixed queen-size bed, and the option to convert into a two-room cabin - perfect for families. 'Le

'Le Lyrial' also offers an additional Grand Deluxe Suite.

- 'Le Lyrial' is outfitted with a technologically advanced stabilizing system to minimize the effects of rough conditions and help keep passengers comfortable at all times.

Space to Meet and Mingle

- Spacious and elegant, 'Le Lyrial's common areas invite casual conversation with fellow guests as well as private reflection and views in quiet corners.
- The Panoramic Lounge and Terrace offer spacious areas ideal for social gatherings, afternoon tea or just relaxing with ocean views.
- The Club offers an elegant atmosphere in the evening, with live music and dancing, while the Theatre is the ideal venue for nightly entertainment, enrichment lectures and movies.

International Cuisine

- The Restaurant offers gourmet and international cuisine while The Compass Grill delivers casual indoor and outdoor dining for breakfast, lunch and themed dinners.
- There is always a selection of light fare and vegetarian dishes, and most special diets can be accommodated with advance notice.
- In-cabin room service is available 24/7.

Personal Butler Service on Board

- Cabin Categories 4-9 on Deck 6 receive the complimentary services of a private butler.
- From ensuring your suite is up to your standards to organizing cocktails on your private balcony, your butler tends to your every need, with grace and efficiency.

'Le Lyrial'

Category 1
Classic Stateroom

Category 2
Deluxe Stateroom

Category 3
Premier Stateroom

Category 4*
Prestige Suite

Category 5*
Premier Two-Room Suite

Category 6*
Privilege Two-Room Suite

Category 7*
Grand Deluxe Two-Room Suite

Category 8*
Grand Privilege Three-Room Suite

Category 9*
Owner's Suite

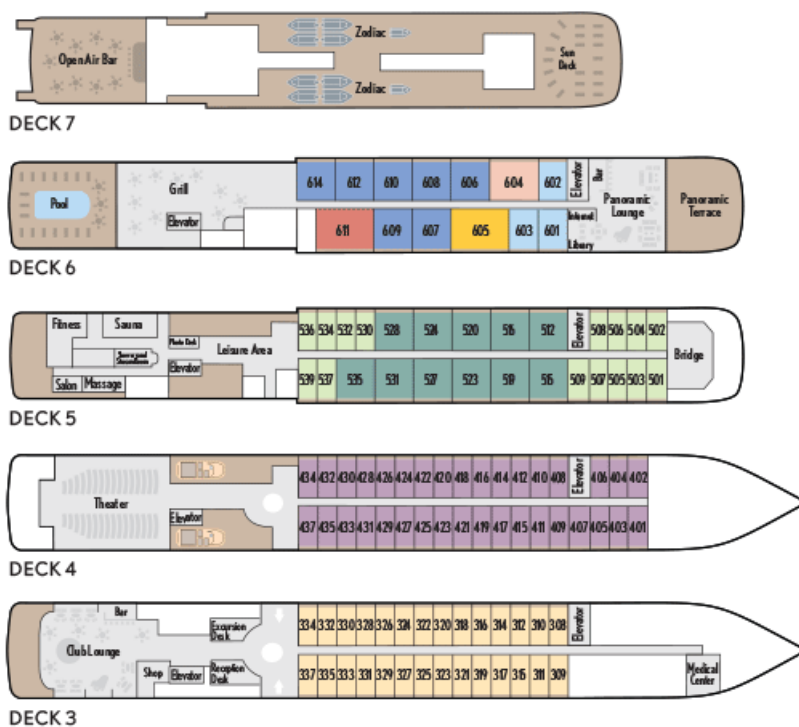

*Butler Service Included



BUTLER SERVICE INCLUDED

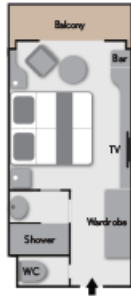

Categories 1-3
Staterooms
Cabin: 18 sq. mt. | Balcony: 4 sq. mt.



Category 4
Prestige Suite
Cabin: 27 sq. mt. | Balcony: 6 sq. mt.

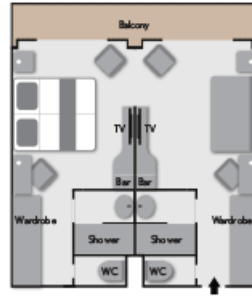

Category 5
Premier Two-Room Suite
Cabin: 36 sq. mt. | Balcony: 8 sq. mt.



Category 6
Privilege Two-Room Suite
Cabin: 36 sq. mt. | Balcony: 8 sq. mt.

BUTLER SERVICE INCLUDED

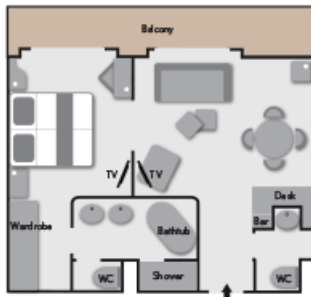

Category 7
Grand Deluxe Two-Room Suite
Cabin: 45 sq. mt. | Balcony: 10 sq. mt.

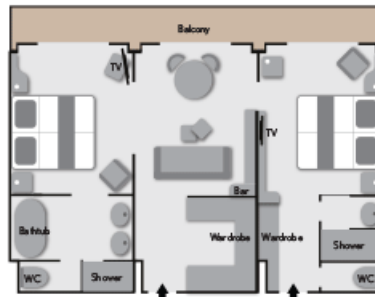

Category 8
Grand Privilege Three-Room Suite
Cabin: 54 sq. mt. | Balcony: 12 sq. mt.

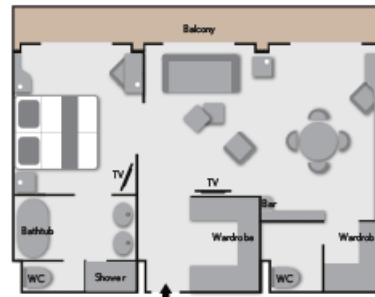

Category 9
Owner's Suite
Cabin: 54 sq. mt. | Balcony: 12 sq. mt.

Palacio Duhau - Park Hyatt Buenos Aires



Palacio Duhau is a superb city hotel and a member of the legendary Park Hyatt portfolio. The building itself is hugely impressive. The exterior retains the wonderful belle-époque architecture of the 1932 French Palace Duhau, whilst the interior is all sleek design and modern décor.

Its stylish, spacious rooms and exclusive suites have street or garden views and are immaculately presented, with modern décor offering a backdrop for the latest technology and luxurious furnishings. All have plush king sized beds, oversized work desks and majestic bathrooms with tub and rain shower. Luxurious touches include Celedonio Lohidoy-designed spa products, 30-inch flat-screen TVs and butler service.

Why we like it

- The rooms and suites are spacious and packed with luxurious touches
- Palacio Duhau is in an ideal central location on Avenida Alvear
- Dining options include the signature Duhau Restaurant and, for something special, the Vinoteca & Cheese Room, which offers fine Argentinian Malbecs and regional cheeses selected by the Maître Fromager
- The Ahin Spa can only be described as 'sumptuous'
- A beautiful, short-course indoor heated swimming pool is located in the spa

Dates & Pricing

Prices are in AUD, per person, based on double occupancy

Dec 20, 2024 - Jan 7, 2025

Cabin Class	Price	Single Supplement	Internal Air (From)	Availability
Le Lyrial: Classic Balcony Stateroom - Category 1	AU\$44,600 NOW ONLY AU\$36,145 pp	AU\$32,300	Included	Call for Availability
Cabin Class	Price	Single Supplement	Internal Air (From)	Availability
Le Lyrial: Deluxe Balcony Stateroom - Category 2	AU\$49,215 NOW ONLY AU\$40,760 pp	AU\$35,760	Included	Call for Availability
Cabin Class	Price	Single Supplement	Internal Air (From)	Availability
Le Lyrial: Premier Balcony Stateroom - Category 3	AU\$52,290 NOW ONLY AU\$43,835 pp	AU\$38,070	Included	Call for Availability
Cabin Class	Price	Single Supplement	Internal Air (From)	Availability
Le Lyrial: Prestige Balcony Suite - Category 4	AU\$70,755 NOW ONLY AU\$62,300 pp	AU\$59,915	Included	Call for Availability
Cabin Class	Price	Single Supplement	Internal Air (From)	Availability
Le Lyrial: Premier Two-Room Balcony Suite - Category 5	AU\$81,520 NOW ONLY AU\$73,065 pp	AU\$70,145	Included	Call for Availability
Cabin Class	Price	Single Supplement	Internal Air (From)	Availability
Le Lyrial: Privilege Two-Room Balcony Suite - Category 6	AU\$85,370 NOW ONLY AU\$76,915 pp	AU\$73,810	Included	Call for Availability
Cabin Class	Price	Single Supplement	Internal Air (From)	Availability
Le Lyrial: Grand Deluxe Two-Room Balcony Suite - Category 7	AU\$93,060 NOW ONLY AU\$84,605 pp	AU\$81,115	Included	Call for Availability
Cabin Class	Price	Single Supplement	Internal Air (From)	Availability
Le Lyrial: Grand Privilege Three-Room Balcony Suite - Category 8	AU\$105,370 NOW ONLY AU\$96,915 pp	AU\$92,810	Included	Call for Availability
Cabin Class	Price	Single Supplement	Internal Air (From)	Availability
Le Lyrial: Owner's Balcony Suite - Category 9	AU\$109,215 NOW ONLY AU\$100,760 pp	AU\$96,455	Included	Call for Availability

Abercrombie & Kent

**Call Us Now on
1300 851 924
within Australia**

Melbourne Office:

T: +61 (0)3 9536 1800

F: +61 (0) 3 9536 1805

E: contact@abercrombiekent.com.au

Address

Level 26 (North Tower)

80 Collins St

Melbourne, VIC, 3000

International:

New Zealand Call: 0800 441 638

Asia Call: 800 4747 7700