



ANTARCTIC CRUISE ADVENTURE (2024)

Embark on the Luxury Expedition Cruise of a lifetime to extraordinary Antarctica, where towering icebergs and massive glaciers showcase flawless beauty.

Cruises, A&K Luxury Expedition Cruises



Antarctica



13 days from AU\$21,530 pp



199 Guests

Journey Overview

Embark on the Luxury Expedition Cruise of a lifetime to extraordinary Antarctica, where towering icebergs and massive glaciers showcase flawless beauty. Discover the effects of rising global temperatures firsthand with enthralling lectures by climate scientist Dr. James McClintock. Enjoy daily Zodiac excursions to the White Continent and witness rare and thrilling wildlife up close — from lively penguin colonies to several species of whale.

Journey Highlights

- Cruise for 10 nights on an exclusively A&K chartered expedition to Antarctica, timed during the peak of the austral summer
- Explore the Antarctic Peninsula for five action-packed days of adventure with A&K's award-winning Expedition Team and daily Zodiac excursions
- Discover rare yet abundant wildlife, such as chinstrap penguin, humpback whale and giant albatross
- Experience a focus on climate change research, joined by special guest and noted Antarctic researcher Dr. James McClintock, who offers a lecture series on the impact of rising global temperatures on this fragile ecosystem
- Begin your journey with a two-night stay in Buenos Aires and explore this vibrant Latin city with your choice of shore excursion

Take 10 with an A&K Expert to Hear More About This Journey



Itinerary

Dec 10: Arrive Buenos Aires, Argentina

Upon arrival in Argentina's capital, you are met and transferred to the Palacio Duhau — Park Hyatt Buenos Aires, where you spend the rest of the day at leisure. Located in the fashionable residential enclave of Recoleta, your contemporary luxury hotel occupies a restored palace dating to 1934.

Palacio Duhau | Park Hyatt Buenos Aires

Dec 11: Buenos Aires | A Capital Like No Other

Latin passion and European romance define Buenos Aires, a dynamic city known for its diverse architecture, vibrant contemporary art scene and lively steakhouses. Today, you might opt for a panoramic city tour complete with a tango demonstration, or simply relax and enjoy your hotel's luxurious amenities. Later this afternoon, meet with your fellow adventurers for a welcome cocktail reception.

Palacio Duhau | Park Hyatt Buenos Aires | Meals: B

Dec 12: Ushuaia | Gateway to Antarctica

Fly to the charming port town of Ushuaia, the southernmost city in the world and your gateway to Antarctica. After lunch at the panoramic Arakur Ushuaia Resort & Spa, opt for a nature walk, or stay put to unwind and savour views spanning the Beagle Channel and the rugged Andean mountainscape beyond. This afternoon, transfer to your ship and settle in. Later this evening, your vessel navigates into the Beagle Channel before heading out to sea.

'Le Lyrial' | Meals: BLD

Dec 13: The Drake Passage | The Adventure Begins

Awake to your first morning aboard. Today, your vessel cruises the Drake Passage, the 965-kilometre-wide confluence of the Atlantic and Pacific oceans.

'Le Lyrial' | Meals: BLD

Dec 14: The Drake Passage | Legendary Crossing

Continue cruising today and join your naturalists on the deck to look for various species of whales and abundant seabirds, which join other mammals in feasting on the krill-rich waters of the Drake Passage. Later in the evening, chat with experts about the wildlife spotted today and learn about the next day's itinerary.

'Le Lyrial' | Meals: BLD

Dec 15: Antarctica | The White Continent

Today, conditions permitting, 'Le Lyrial' cruises the Antarctic Sound. Located at the northernmost tip of the Antarctic mainland, the sound harbours a proliferation of giant icebergs and one of Antarctica's largest colonies of Adélie penguin. Your Expedition Team scouts for opportunities to land on remote, biodiverse islands.

'Le Lyrial' | Meals: BLD

Dec 16: Antarctica | Islands of Discovery

This morning your Expedition Team may chart a course for the South Shetland Islands, an enclave of captivating history, geology and wildlife. Here, your team looks for the best opportunities to visit volcanic islands and historic sites, as well as gentoo, Adélie and chinstrap penguin rookeries.

'Le Lyrial' | Meals: BLD

Dec 17: Antarctica | Scenic Waterways

Bordering the South Shetland Islands along the Antarctic continent, the Danco Coast is famed for its scenic, jaw-dropping waterways. From the comfort of your vessel, you may sail through some of its most stunning and photogenic channels, straits and bays.

'Le Lyrial' | Meals: BLD

Dec 18: Antarctica | Wondrous Wilderness

Continue exploring the Antarctic Peninsula and after a full day of adventure, recap the day's discoveries with your naturalist guides, spend time on deck chatting with fellow guests and take in enriching presentations from the Expedition Team. Later, unwind over cocktails in the lounge before dinner in the elegant dining room.

'Le Lyrial' | Meals: BLD

Dec 19: Antarctica | A Twilight to Remember

Possible excursions today may include a Zodiac cruise through an area renowned for its prolific humpback whale sightings or visits to sites known to harbour gentoo penguin, kelp gull and breeding skua. Following today's exciting excursions, relax or seize the opportunity to capture photos amid Antarctica's distinctively atmospheric twilight.

'Le Lyrial' | Meals: BLD

Dec 20: The Drake Passage | A Parting Glimpse

Bid farewell to Antarctica and begin your cruise back to Ushuaia. The ship's return through the Drake Passage is an interlude for recap and reflection, offering time to compare notes with your expert lecturers on the wildlife, history and geology of the White Continent.

'Le Lyrial' | Meals: BLD

Dec 21: The Drake Passage | Memorable Return

While cruising through this historic passage, you may spot various Drake Passage seabird species, including the elusive albatross and the giant petrel.

'Le Lyrial' | Meals: B

Dec 22: Depart Ushuaia

'Le Lyrial' is scheduled to dock in Ushuaia this morning. After breakfast, bid farewell to your crew and fellow guests before disembarking. Then, transfer to the airport for your connecting flight to Buenos Aires.

Meals: B

Journey Details:

Note: Itinerary is for guidance purposes only and may be adjusted due to unforeseen circumstances including weather, wildlife, ice, medical emergencies and other conditions beyond A&K's control at the sole discretion of the Captain.

This journey contains some active elements, including Zodiac boat excursions, walks over uneven terrain and optional, challenging hikes.

Buenos Aires/Ushuaia/Buenos Aires Economy Class flights included.

Minimum age is 7 years old.

Categories 4-9 include room upgrade at the hotel and butler service aboard the ship.

First group event: excursion on Dec 11.

Last group event: disembarkation at 9:00 a.m. on Dec 22.

Included with this Luxury Expedition Cruise

- An Exclusively Chartered, All-Inclusive Voyage Led by A&K's Expedition Team
- Pre-Cruise Stay at Stylish, Ideally Located Hotel and A&K-Led Excursion
- Airport Meet and Greet and Transfers
- Private Balcony with Every Onboard Accommodation and Butler Service with Every Suite
- Maximum Personnel-to-Guest Ratio of 1 to 1.3 and ship occupancy limited to 80 percent
- Culinary Program Featuring French-Inspired Cuisine, Including House Drinks, Afternoon Tea and Pastries
- 24-Hour Room Service and Breakfast in Bed on board
- Complimentary Expedition Parka, Backpack and Water Bottle, and Use of Waterproof Pants, Boots and Trekking Poles
- Zodiac Excursions Led by A&K Expert Naturalist Driver-Guides
- Traveller's Valet Laundry Service on board
- All Gratuities, Port Charges and Taxes
- Complimentary Wi-Fi on Board and in Hotels
- Onboard Service from an English-Speaking Staff, Including an Accredited Physician
- 24/7 A&K On-Call Support

Map



Extensions



Iguazu Falls Pre-Tour Extension (2025)

[See Details](#)

Accommodation

Le Lyrial



An A&K voyage to Antarctica offers the opportunity to experience the world's most pristine region at its very best on board the comfortable and sophisticated Le Lyrial. Enjoy its stunning blue palette inspired by the Vega star, all-balcony staterooms and suites, and the finest expedition staff cruising the southern ocean today.

On other cruises to different destinations, she carries more than 264 passengers: on voyages with A&K, we limit her capacity to just 199 clients. Fewer passengers in turn allows for more shore excursions each day and cabins with private balconies for every guest.

Relax in the on-board spa and hammam or take a dip in the outdoor heated saltwater pool with panoramic ocean views to the horizon.

The two on-board restaurants offer a selection of gourmet and international cuisine while the airy and elegant communal areas provide the perfect mix of quiet corners and sociable spaces. By day, enjoy a series of enriching lectures by leading experts about your natural surroundings. Then by night, the Club Lounge and the Theatre take care of your evening's entertainment with a variety of live music shows and film screenings.

Amenities

- All outside staterooms and suites offer a private balcony when chartered by A&K
- Complimentary butler service for Deck 6, categories 4-9
- Sun deck and multiple outer deck observation areas
- Outside heated saltwater pool
- Library with extensive selection of books and reading areas
- Panoramic lounge and terrace
- Three bars and a boutique
- Fitness centre with state-of-the-art equipment
- Hairdresser offering full-service hair styling, manicures and pedicures
- Spa and hammam (steam room)
- On-board medical facilities with certified doctor
- 24-hour room service and laundry services
- The Club lounge hosts live music and dancing
- The Theatre offers unobstructed-view seating for live performances and film screenings
- Wireless internet access throughout the ship
- Dynamic positioning system

Strength and Style

- Sophisticated design, innovative marine technology and a convenient layout aided by three passenger elevators are among 'Le Lyrial's' many features.
- On A&K voyages, we limit her capacity to just 199 guests, allowing for more shore excursions each day and cabins with private balconies for every guest.

Safety

- Safety is first and foremost on board sturdy 'Le Lyrial.'
- The ship features the latest communication, navigational and safety equipment.
- A&K's English-speaking staff is readily available to assist and instruct on safety at all times during your cruise.

Environmentally Sound Operations

- In keeping with A&K's longstanding commitment to environmental conservation, 'Le Lyrial' is equipped with the most eco-friendly technology available today.
- Our expeditions exceed all environmental protocols, including those set by the National Science Foundation, Environmental Protection Agency and Antarctic Treaty Party nations.

Rest and Relaxation Redefined

- Among the most comfortable available on any polar expedition ship, all 108 cabins are fully equipped and feature bedding configurations that range from king-size beds to two single beds.
- Premier and Privilege Two-Room Suites feature a sofa that converts to a fixed queen-size bed, and the option to convert into a two-room cabin - perfect for families. 'Le

'Le Lyrial' also offers an additional Grand Deluxe Suite.

- 'Le Lyrial' is outfitted with a technologically advanced stabilizing system to minimize the effects of rough conditions and help keep passengers comfortable at all times.

Space to Meet and Mingle

- Spacious and elegant, 'Le Lyrial's common areas invite casual conversation with fellow guests as well as private reflection and views in quiet corners.
- The Panoramic Lounge and Terrace offer spacious areas ideal for social gatherings, afternoon tea or just relaxing with ocean views.
- The Club offers an elegant atmosphere in the evening, with live music and dancing, while the Theatre is the ideal venue for nightly entertainment, enrichment lectures and movies.

International Cuisine

- The Restaurant offers gourmet and international cuisine while The Compass Grill delivers casual indoor and outdoor dining for breakfast, lunch and themed dinners.
- There is always a selection of light fare and vegetarian dishes, and most special diets can be accommodated with advance notice.
- In-cabin room service is available 24/7.

Personal Butler Service on Board

- Cabin Categories 4-9 on Deck 6 receive the complimentary services of a private butler.
- From ensuring your suite is up to your standards to organizing cocktails on your private balcony, your butler tends to your every need, with grace and efficiency.

'Le Lyrial'

Category 1
Classic Stateroom

Category 2
Deluxe Stateroom

Category 3
Premier Stateroom

Category 4*
Prestige Suite

Category 5*
Premier Two-Room Suite

Category 6*
Privilege Two-Room Suite

Category 7*
Grand Deluxe
Two-Room Suite

Category 8*
Grand Privilege
Three-Room Suite

Category 9*
Owner's Suite

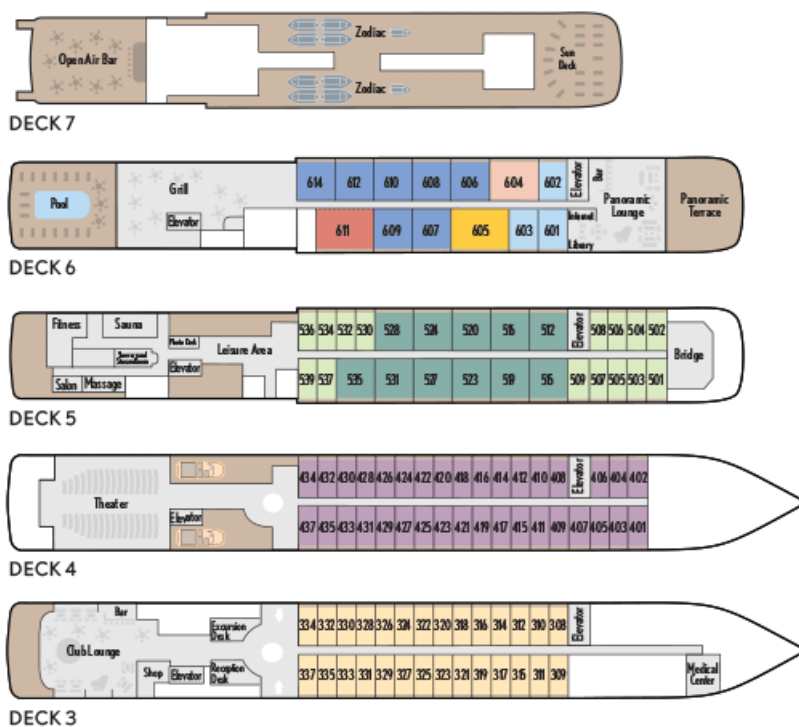

*Butler Service Included



BUTLER SERVICE INCLUDED

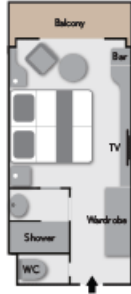

Categories 1-3
Staterooms
Cabin: 18 sq. mt. | Balcony: 4 sq. mt.

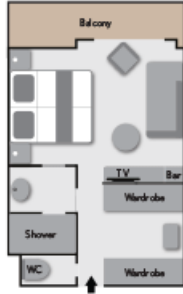

Category 4
Prestige Suite
Cabin: 27 sq. mt. | Balcony: 6 sq. mt.

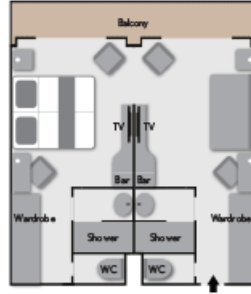

Category 5
Premier Two-Room Suite
Cabin: 36 sq. mt. | Balcony: 8 sq. mt.



Category 6
Privilege Two-Room Suite
Cabin: 36 sq. mt. | Balcony: 8 sq. mt.

BUTLER SERVICE INCLUDED

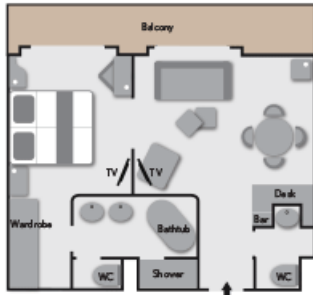

Category 7
Grand Deluxe Two-Room Suite
Cabin: 45 sq. mt. | Balcony: 10 sq. mt.

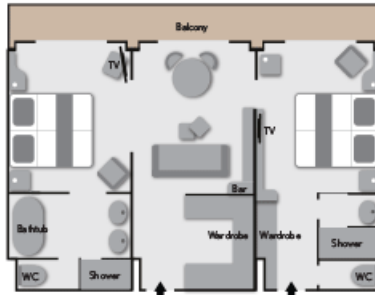

Category 8
Grand Privilege Three-Room Suite
Cabin: 54 sq. mt. | Balcony: 12 sq. mt.

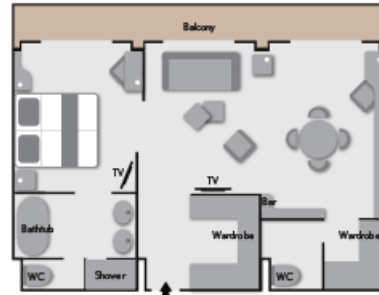

Category 9
Owner's Suite
Cabin: 54 sq. mt. | Balcony: 12 sq. mt.

Palacio Duhau - Park Hyatt Buenos Aires



Palacio Duhau is a superb city hotel and a member of the legendary Park Hyatt portfolio. The building itself is hugely impressive. The exterior retains the wonderful belle-époque architecture of the 1932 French Palace Duhau, whilst the interior is all sleek design and modern décor.

Its stylish, spacious rooms and exclusive suites have street or garden views and are immaculately presented, with modern décor offering a backdrop for the latest technology and luxurious furnishings. All have plush king sized beds, oversized work desks and majestic bathrooms with tub and rain shower. Luxurious touches include Celedonio Lohidoy-designed spa products, 30-inch flat-screen TVs and butler service.

Why we like it

- The rooms and suites are spacious and packed with luxurious touches
- Palacio Duhau is in an ideal central location on Avenida Alvear
- Dining options include the signature Duhau Restaurant and, for something special, the Vinoteca & Cheese Room, which offers fine Argentinian Malbecs and regional cheeses selected by the Maître Fromager
- The Ahin Spa can only be described as 'sumptuous'
- A beautiful, short-course indoor heated swimming pool is located in the spa

Dates & Pricing

Prices are in AUD, per person, based on double occupancy

Dec 10, 2024 - Dec 22, 2024

Cabin Class	Price	Single Supplement	Internal Air (From)	Availability
Le Lyrial: Classic Balcony Stateroom - Category 1	AU\$28,445 NOW ONLY AU\$21,530 pp	AU\$20,190	Included	Call for Availability
Cabin Class	Price	Single Supplement	Internal Air (From)	Availability
Le Lyrial: Deluxe Balcony Stateroom - Category 2	AU\$31,520 NOW ONLY AU\$24,605 pp	AU\$22,500	Included	Call for Availability
Cabin Class	Price	Single Supplement	Internal Air (From)	Availability
Le Lyrial: Premier Balcony Stateroom - Category 3	AU\$33,060 NOW ONLY AU\$26,145 pp	AU\$23,655	Included	Call for Availability
Cabin Class	Price	Single Supplement	Internal Air (From)	Availability
Le Lyrial: Prestige Balcony Suite - Category 4	AU\$46,905 NOW ONLY AU\$39,990 pp	AU\$38,730	Included	Call for Availability
Cabin Class	Price	Single Supplement	Internal Air (From)	Availability
Le Lyrial: Premier Two-Room Balcony Suite - Category 5	AU\$55,370 NOW ONLY AU\$48,455 pp	AU\$46,760	Included	Call for Availability
Cabin Class	Price	Single Supplement	Internal Air (From)	Availability
Le Lyrial: Privilege Two-Room Balcony Suite - Category 6	AU\$58,445 NOW ONLY AU\$51,530 pp	AU\$49,685	Included	Call for Availability
Cabin Class	Price	Single Supplement	Internal Air (From)	Availability
Le Lyrial: Grand Deluxe Two-Room Balcony Suite - Category 7	AU\$62,290 NOW ONLY AU\$55,375 pp	AU\$53,345	Included	Call for Availability
Cabin Class	Price	Single Supplement	Internal Air (From)	Availability
Le Lyrial: Grand Privilege Three-Room Balcony Suite - Category 8	AU\$69,985 NOW ONLY AU\$63,070 pp	AU\$60,655	Included	Call for Availability
Cabin Class	Price	Single Supplement	Internal Air (From)	Availability
Le Lyrial: Owner's Balcony Suite - Category 9	AU\$73,830 NOW ONLY AU\$66,915 pp	AU\$64,300	Included	Call for Availability

Abercrombie & Kent

**Call Us Now on
1300 851 924
within Australia**

Melbourne Office:

T: +61 (0)3 9536 1800

F: +61 (0) 3 9536 1805

E: contact@abercrombiekent.com.au

Address

Level 26 (North Tower)

80 Collins St

Melbourne, VIC, 3000

International:

New Zealand Call: 0800 441 638

Asia Call: 800 4747 7700